

# AXOR

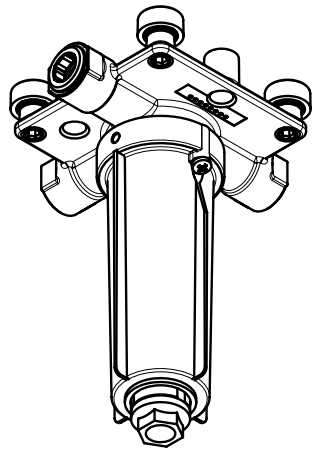

ZH / 用户手册 / 组装说明

EN / Instructions for use / Assembly instructions

02

02

AXOR

26434187

INSTALLATION

**△ 安全技巧**

- △ 装配时为避免挤压和切割受伤, 必须戴上手套.
- △ 本产品只允许作为洗浴, 卫生和洁身之用.

**安装提示**

- / 安装前必须检查产品是否受到运输损害. 安装后将不认可运输损害或表面损伤.
- / 管道和阀门必须根据通用标准进行安装, 冲洗和检查.
- / 请遵守当地国家现行的安装规定.
- / 头顶花洒应当安装到天花板上, 天花板必须有足够的承重能力.
- / 仅可使用合适的紧固材料! 附带的螺丝和木钉仅适用于混凝土.

**符号说明**

-  请勿使用含有乙酸的硅胶!
-  **安装实例** (参见第页 04)
-  **大小** (参见第页 19)
-  **备用零件** (参见第页 03)
-  **选装附件** (参见第页 03)  
不在供货范围内
- / 转接器 #93941000

**△ SAFETY NOTES**

- △ Gloves should be worn during installation to prevent crushing and cutting injuries.
- △ The product may only be used for bathing, hygienic and body cleaning purposes.

**INSTALLATION INSTRUCTIONS**

- / Prior to installation, inspect the product for transport damages. After it has been installed, no transport or surface damage will be honoured.
- / The pipes and the fixture must be installed, flushed and tested as per the applicable standards.
- / The plumbing codes applicable in the respective countries must be observed.
- / The ceiling to which the overhead shower is to mounted must have sufficient bearing capacity.
- / Only suitable fastening material may be used! The enclosed screws and plugs are only suitable for concrete.

**SYMBOL DESCRIPTION**

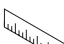
-  Do not use silicone containing acetic acid!
-  **INSTALLATION EXAMPLE**  
(see page 04)
-  **DIMENSIONS** (see page 19)
-  **SPARE PARTS** (see page 03)
-  **SPECIAL ACCESSORIES**  
(see page 03)  
order as an extra
- / Adapter #93941000

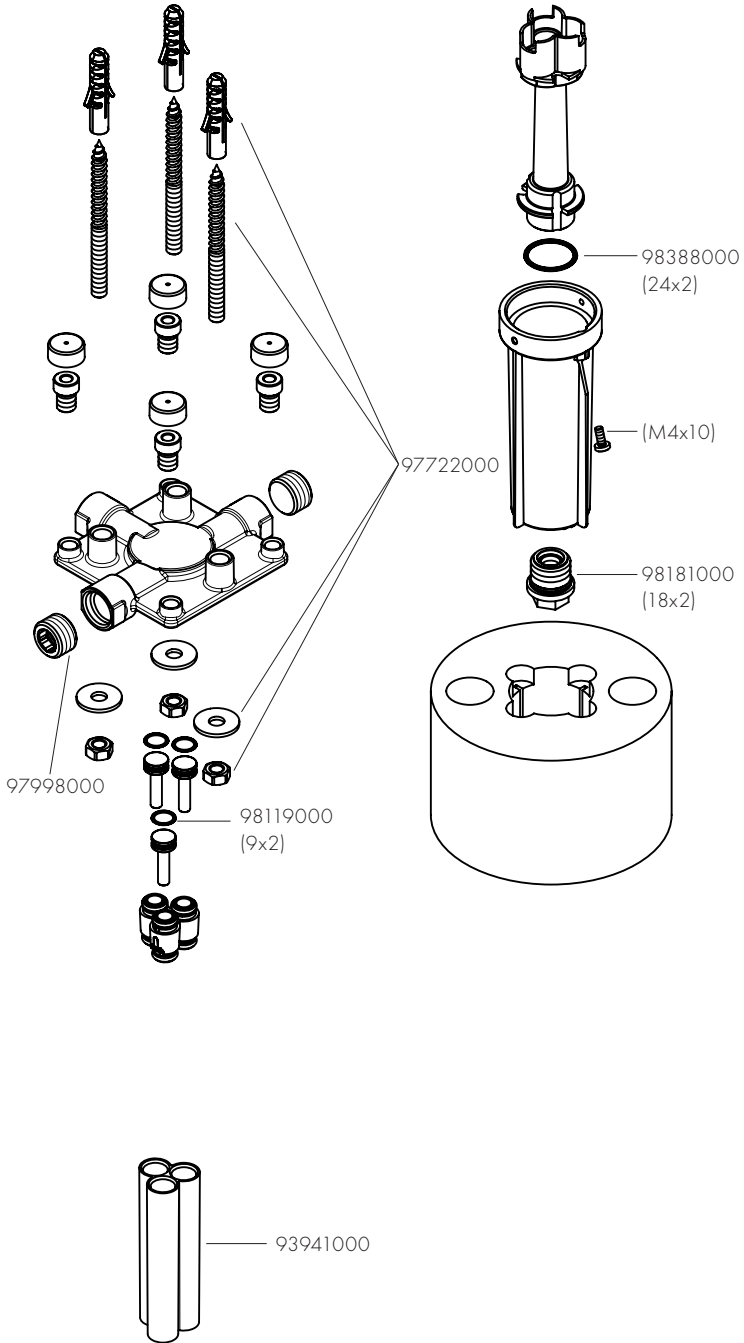



AXOR 460/300 ljet  
35277XX7

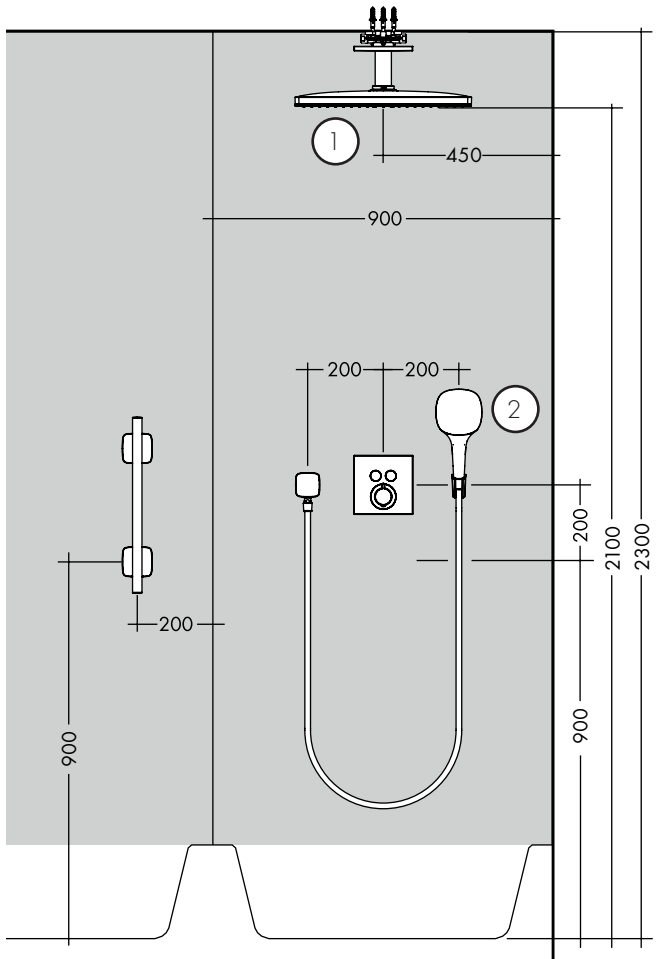
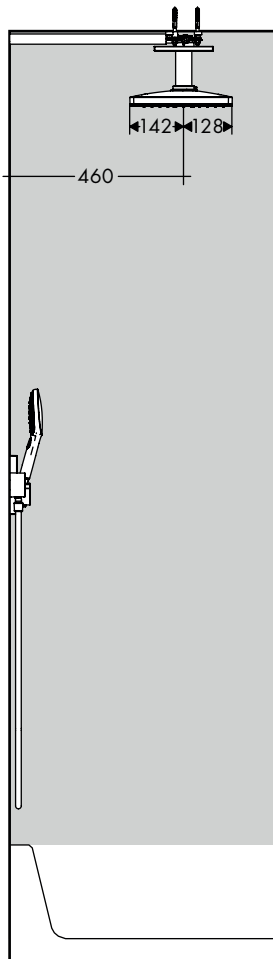
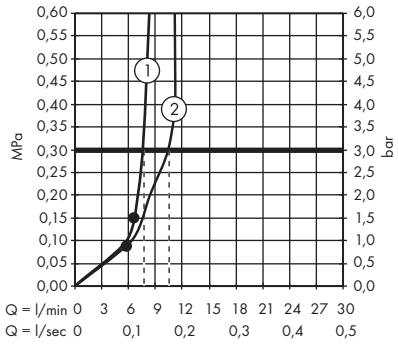

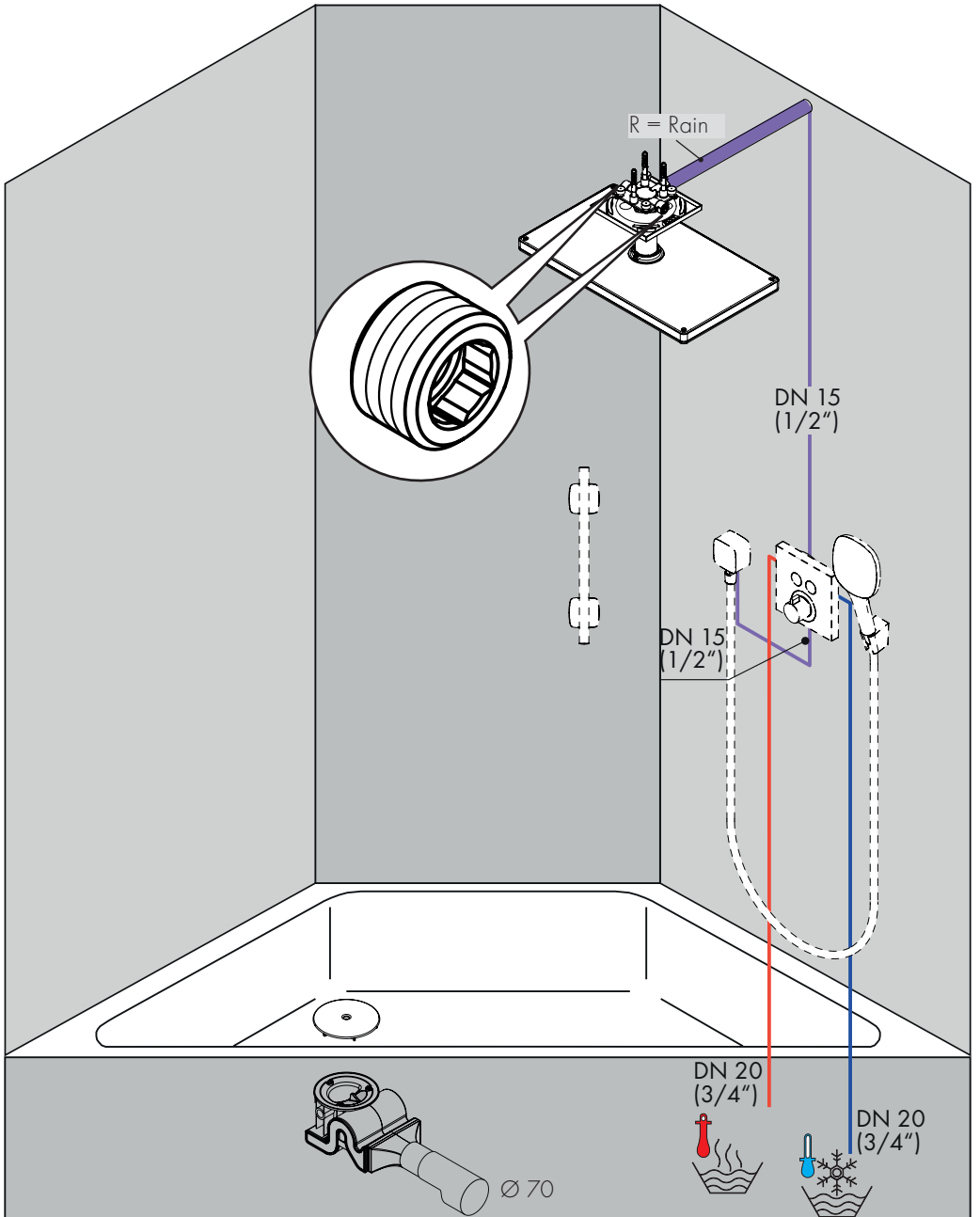



AXOR 460/300 2jet  
35279XX7

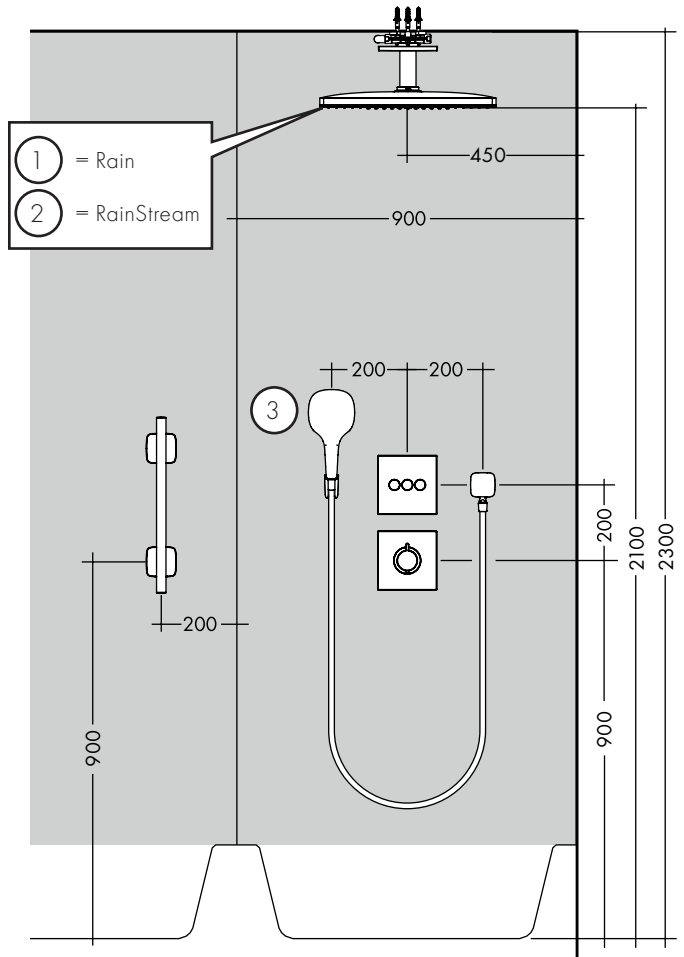
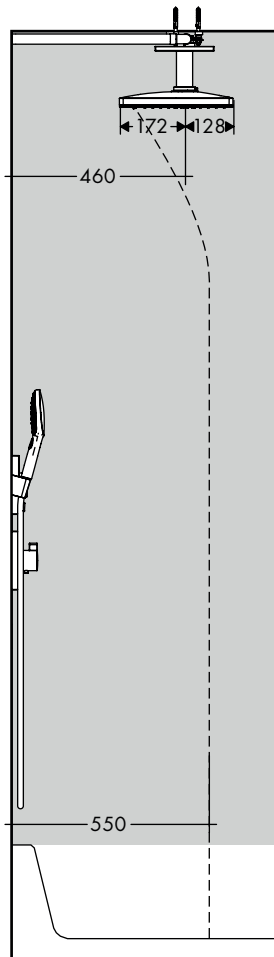
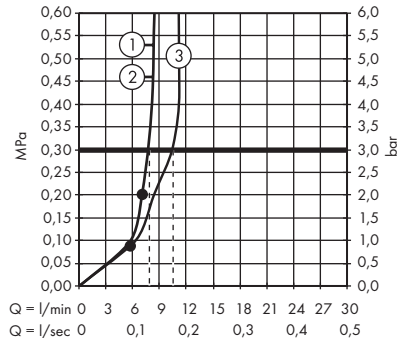

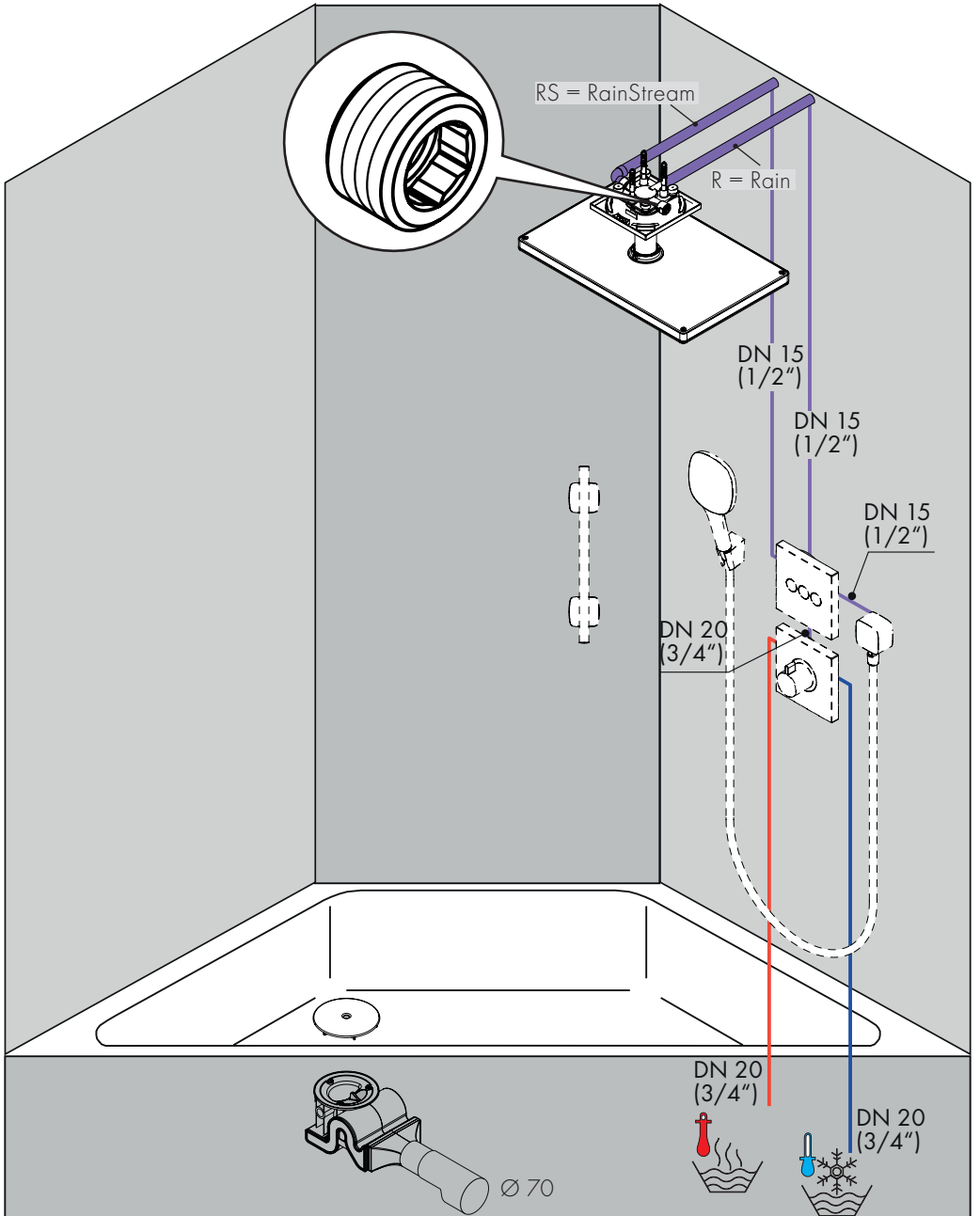



AXOR 460/300 3jet  
35281XX7

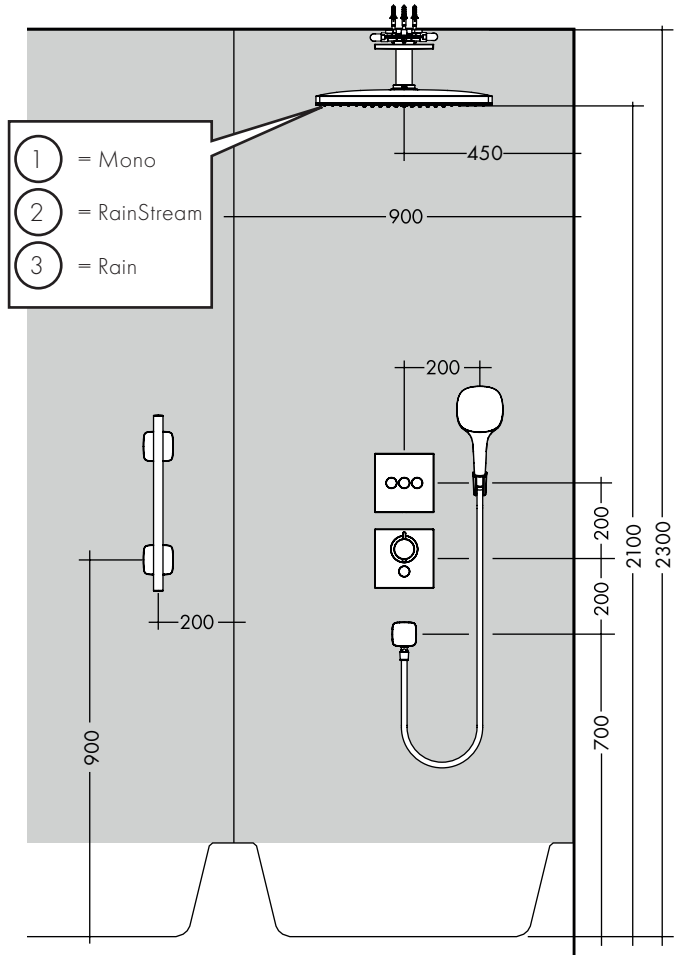
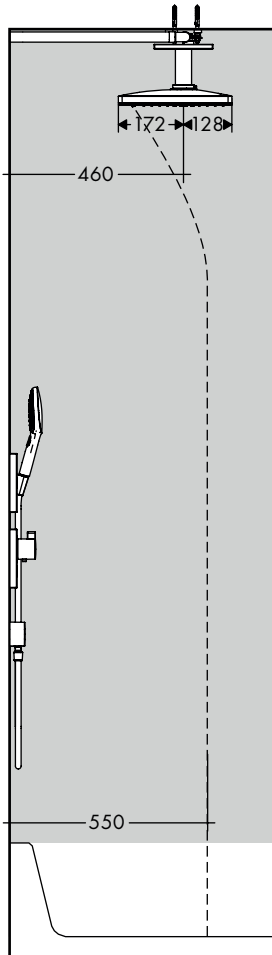
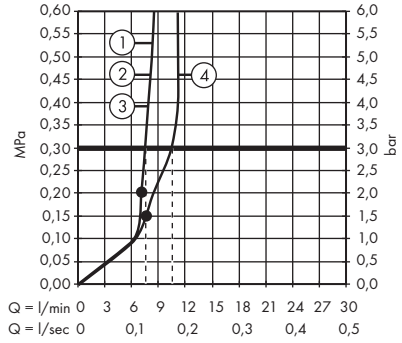



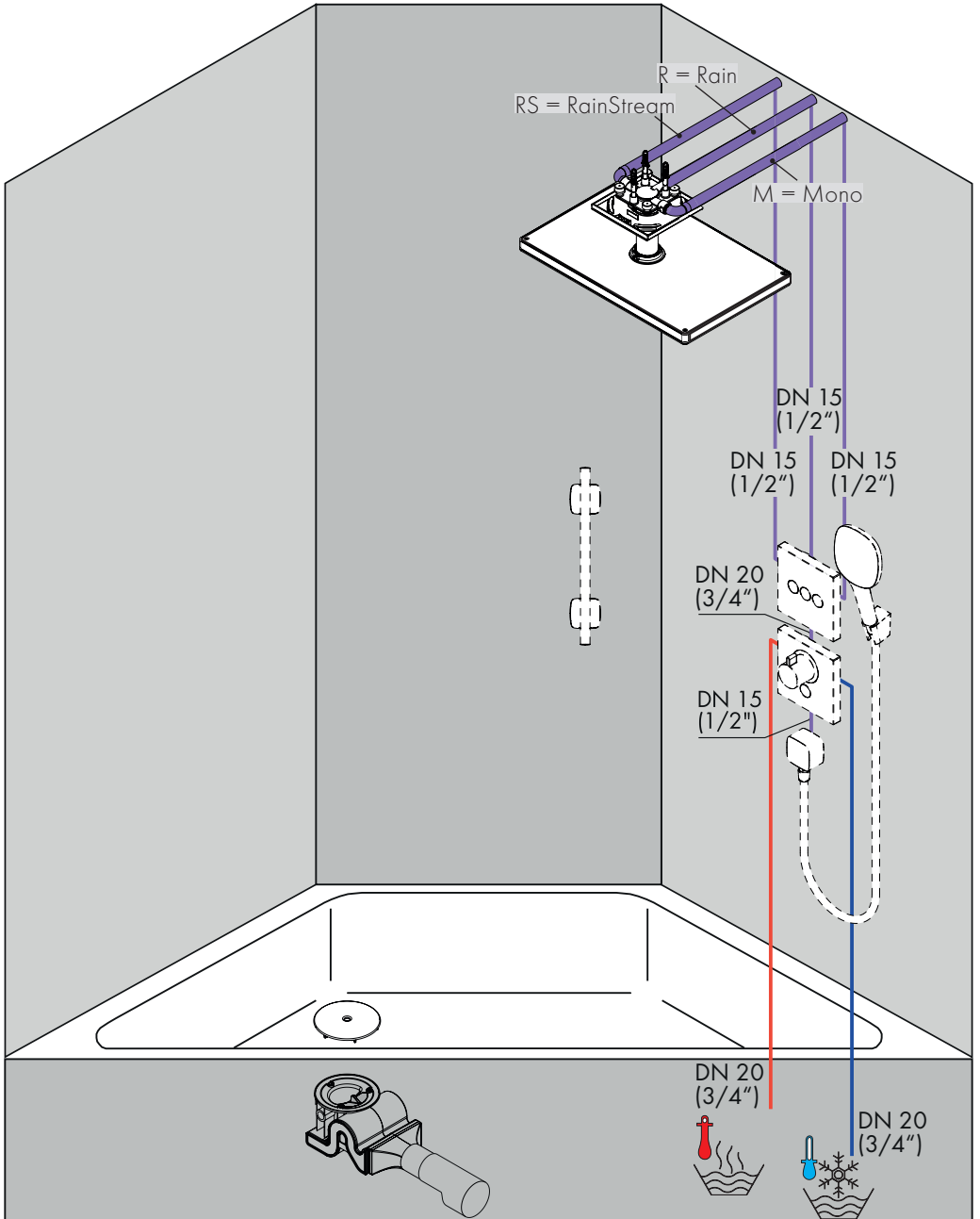

AXOR 250 1jet  
35286XX7

AXOR 250 1jet  
35308XX7

AXOR 300 1jet  
35301XX7

AXOR 300 1jet  
35316XX7

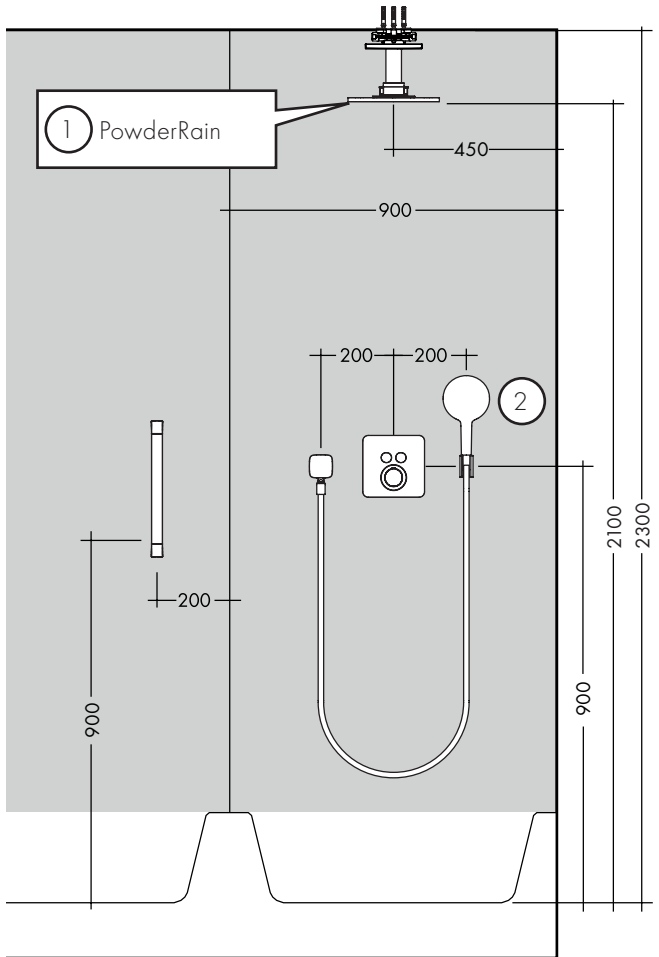
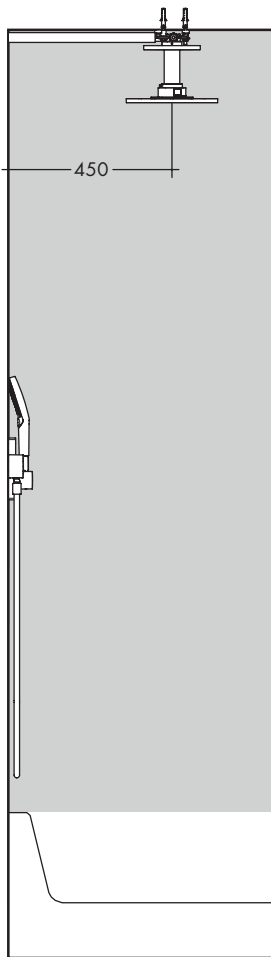
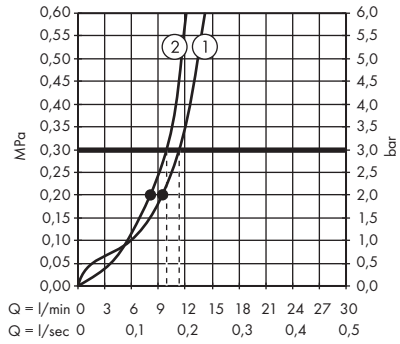

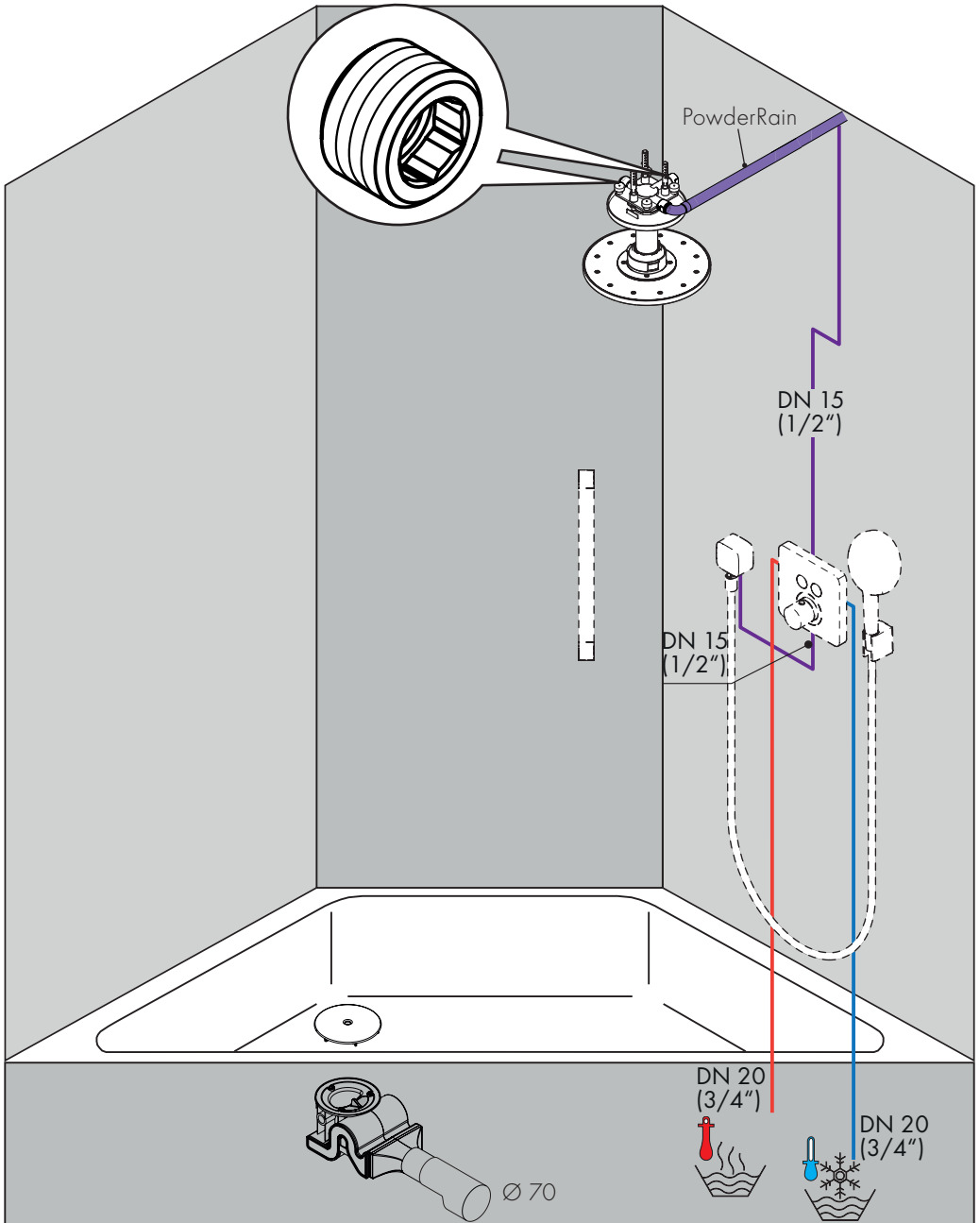



AXOR One 280 2jet  
48494XX7

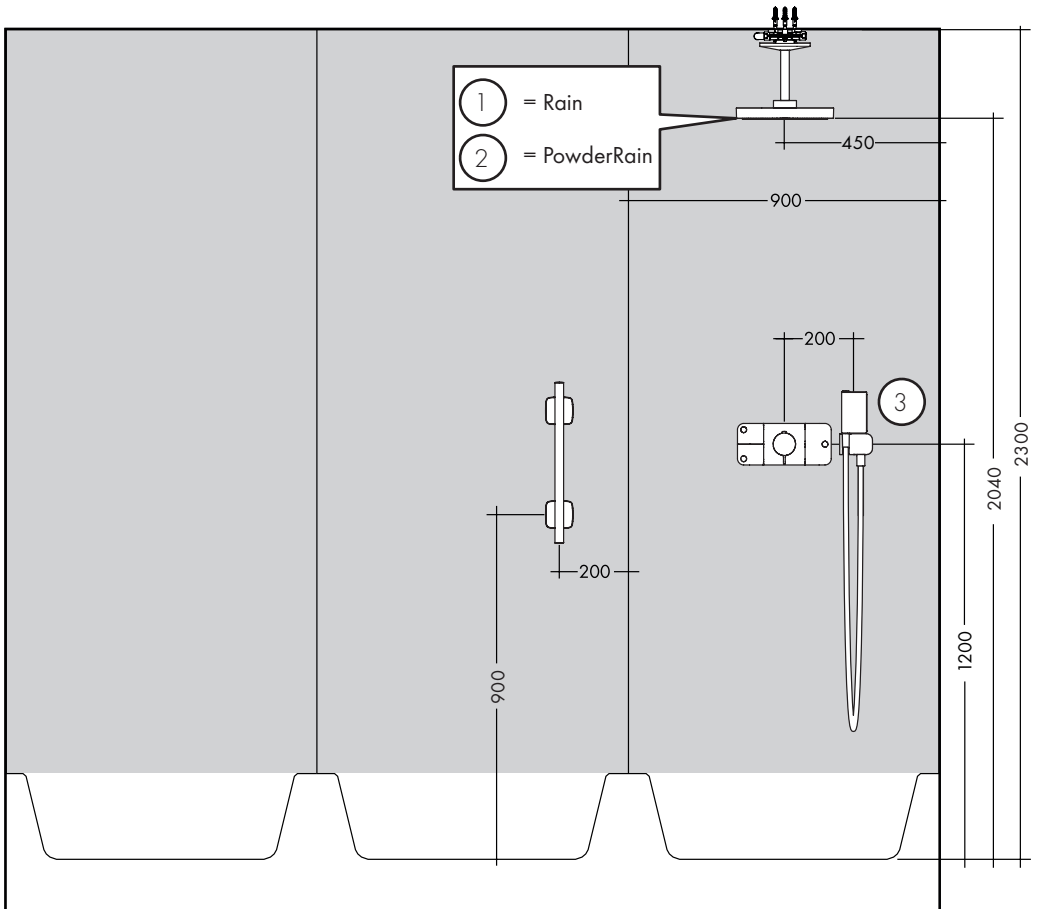
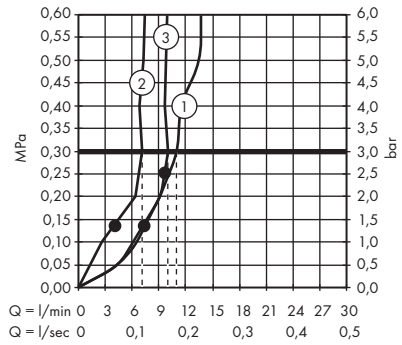

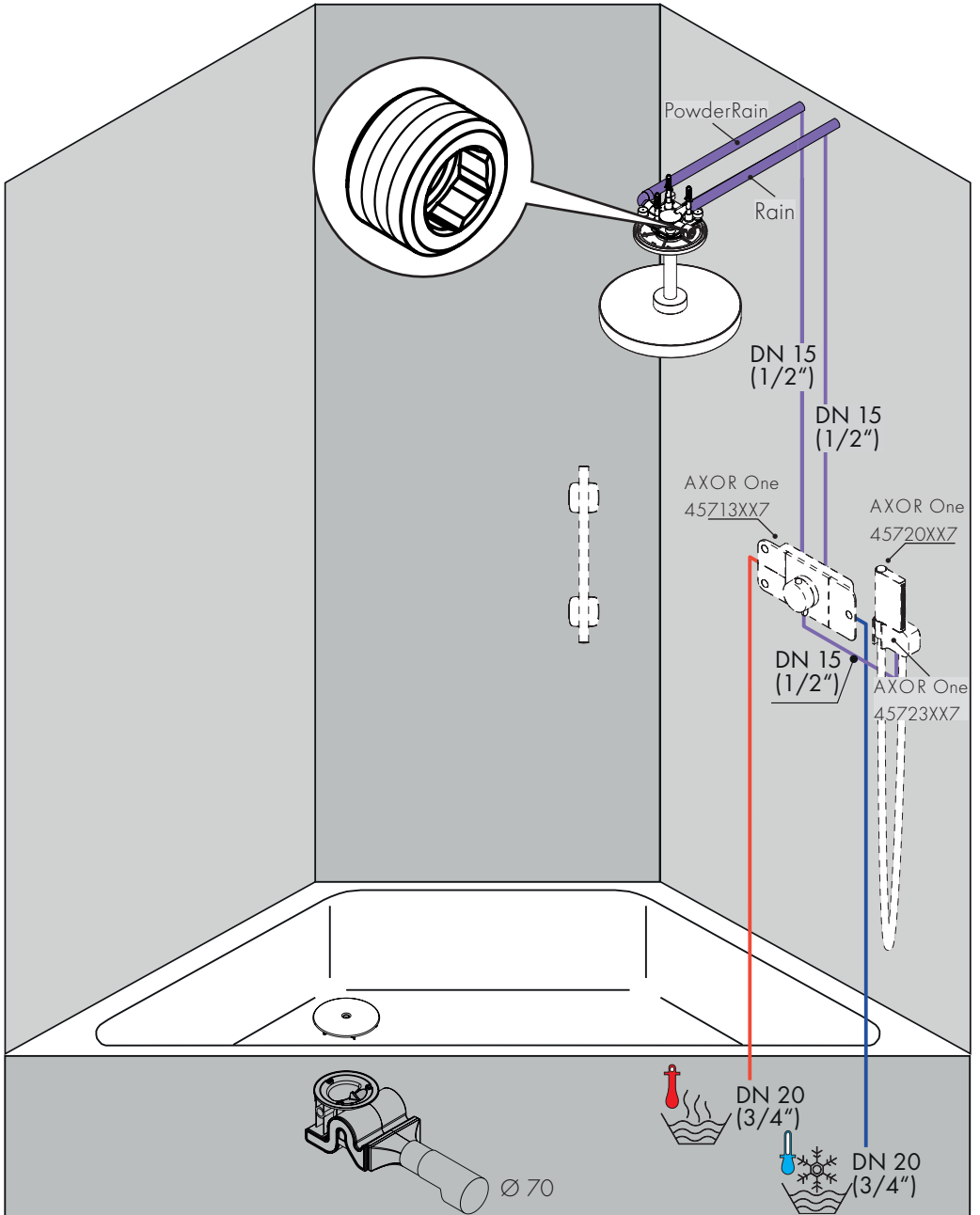

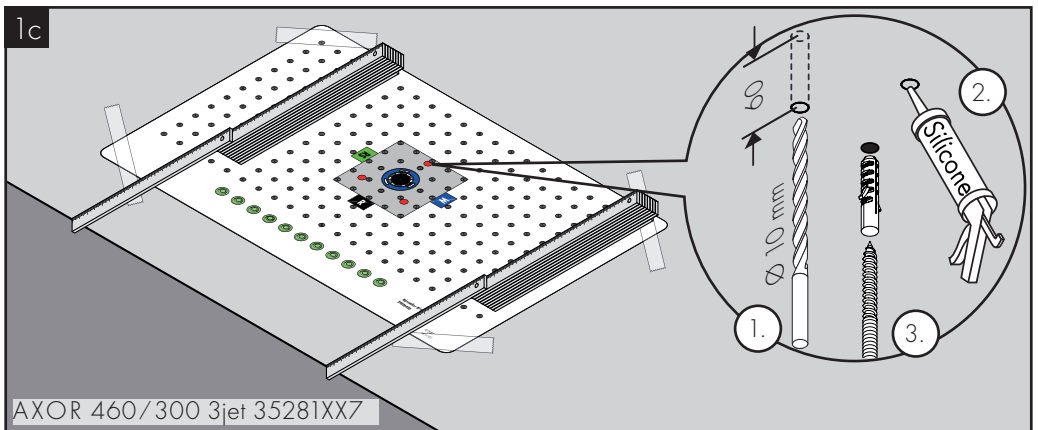
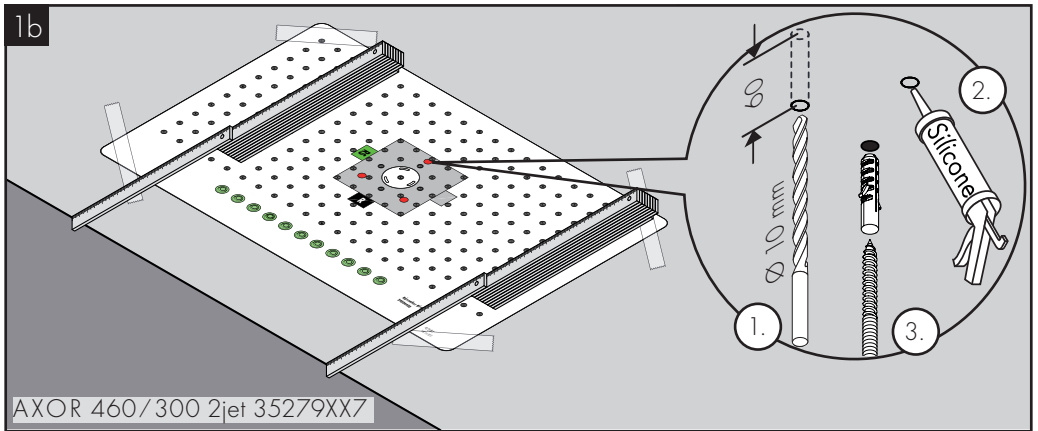
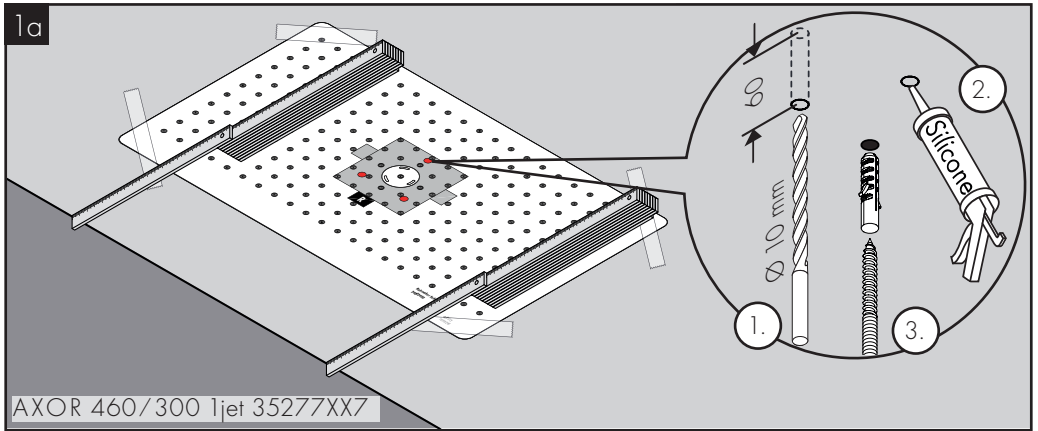

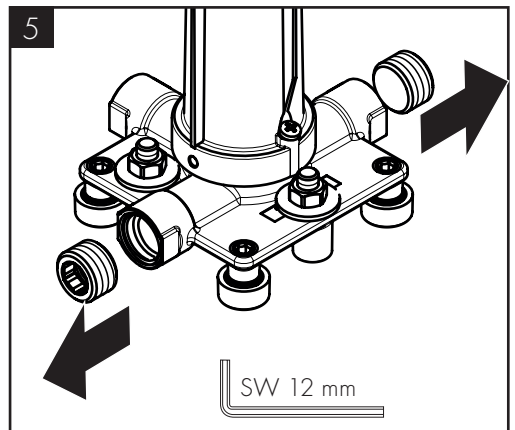
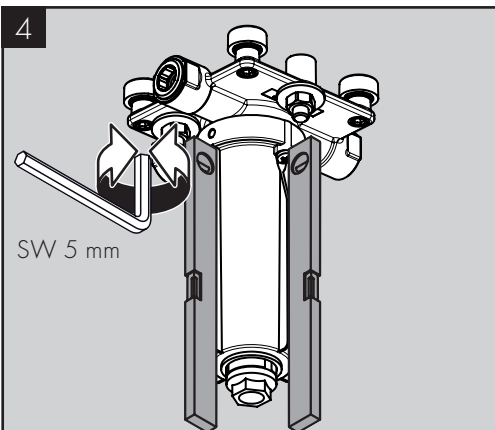
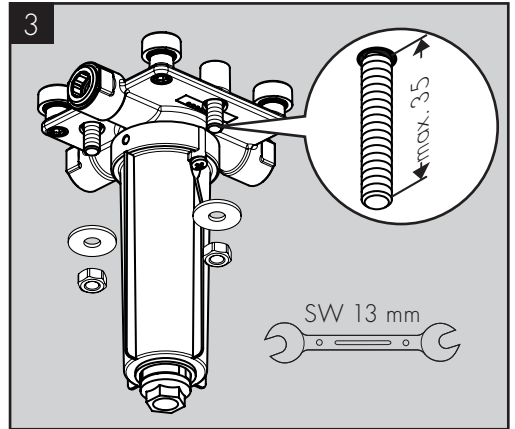
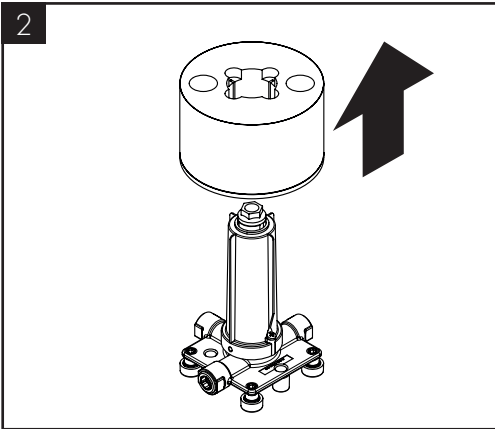
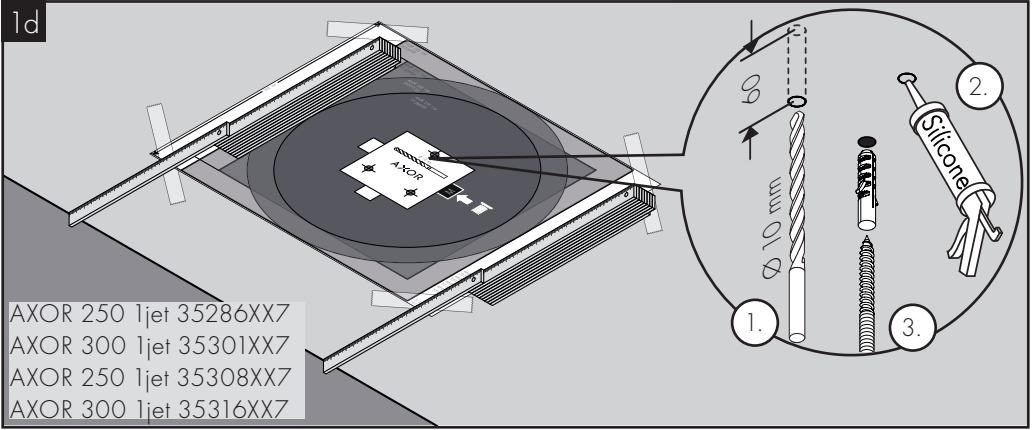

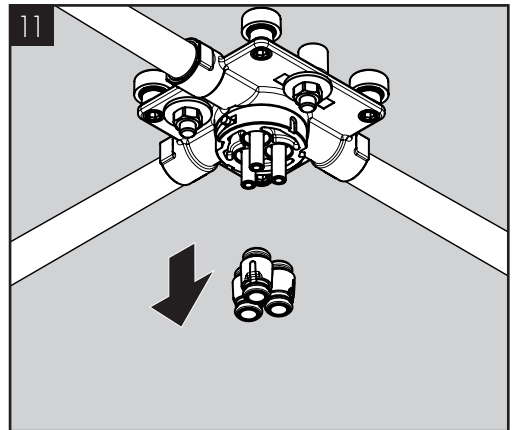
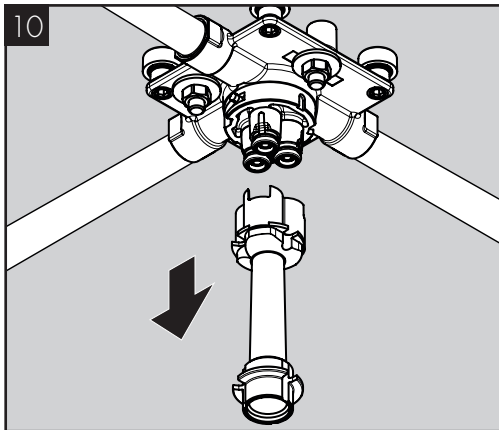
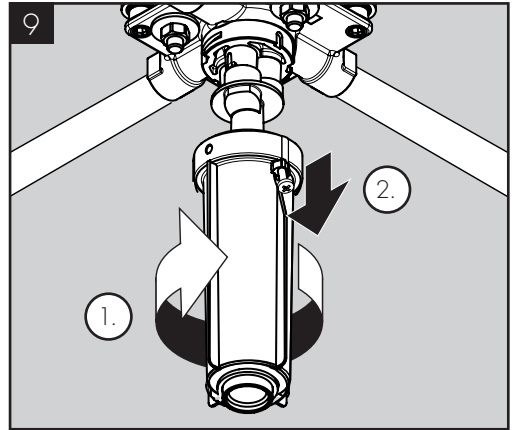
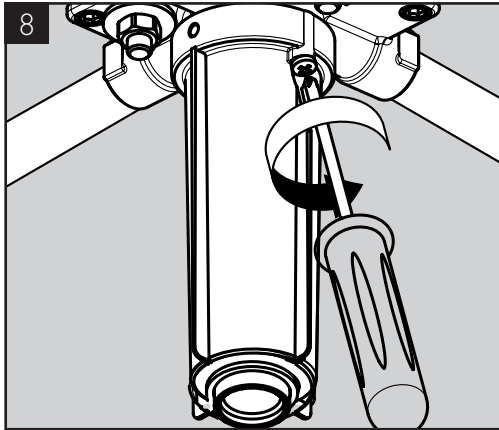
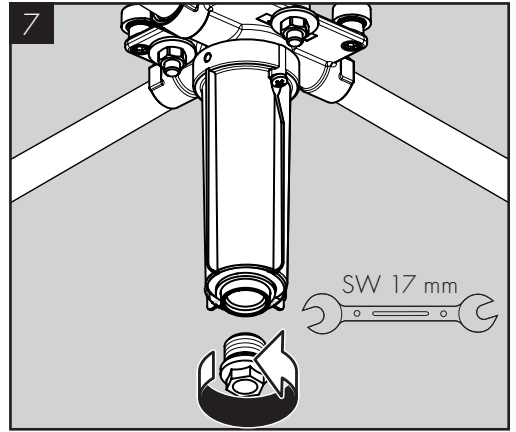
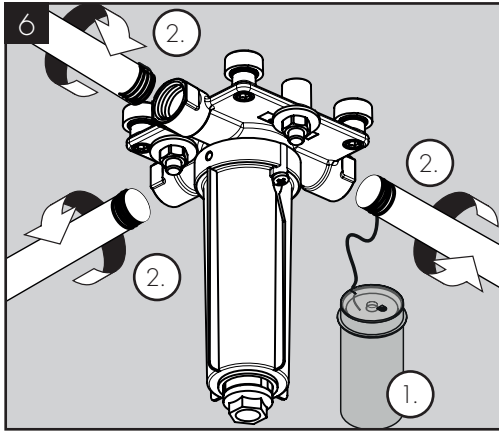



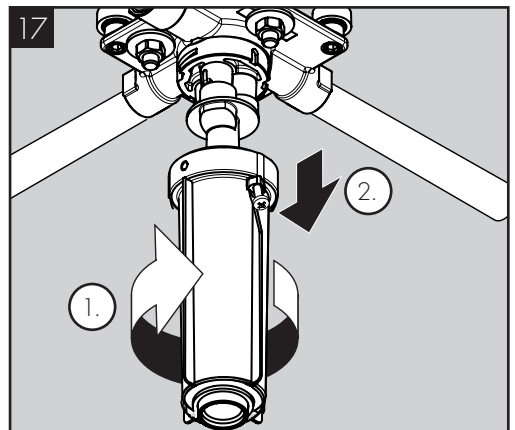
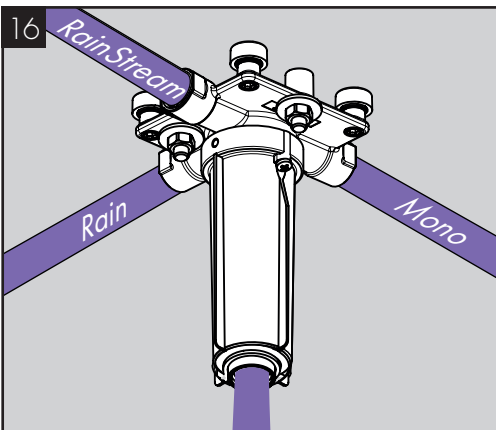
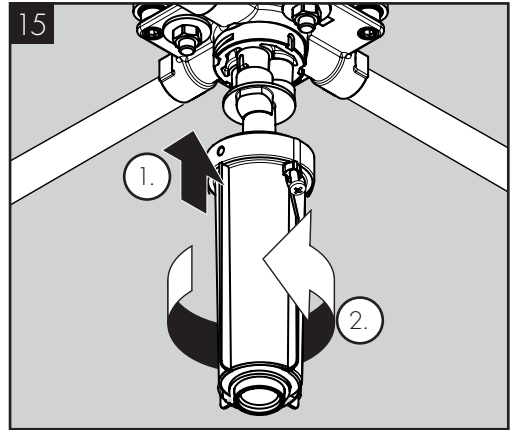
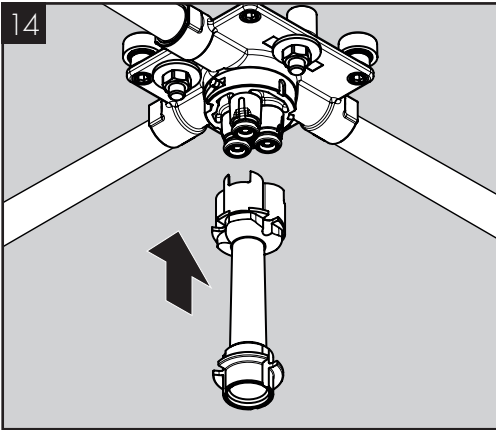
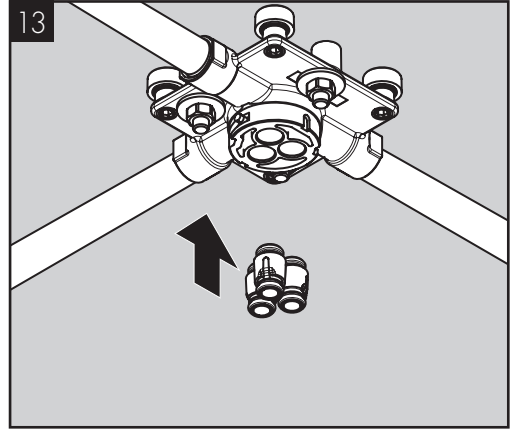
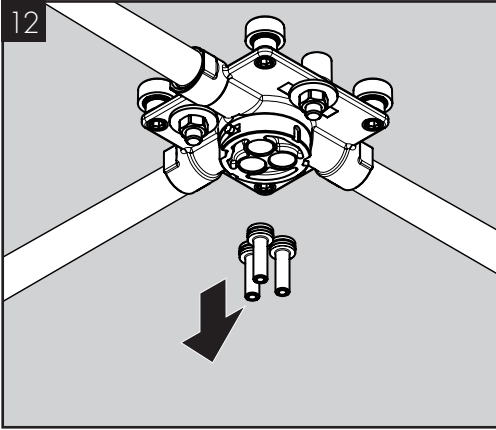

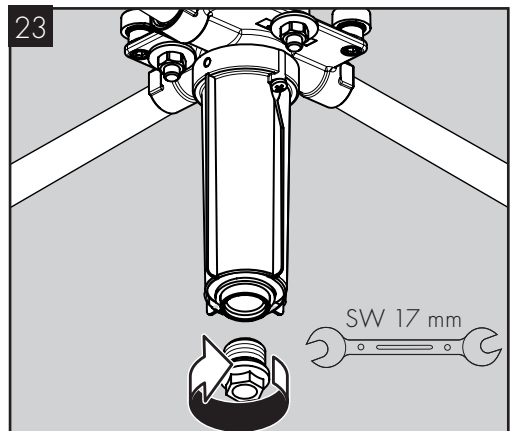
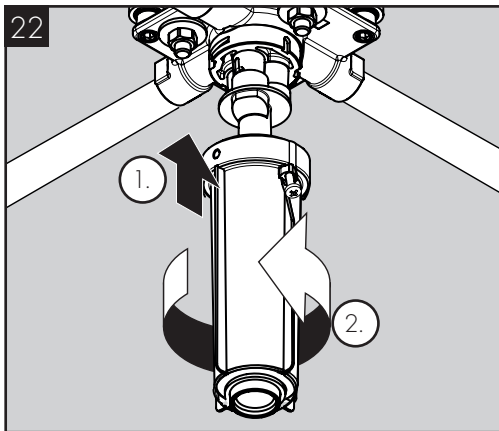
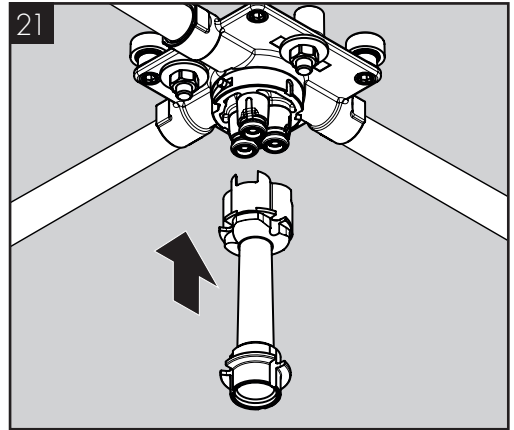
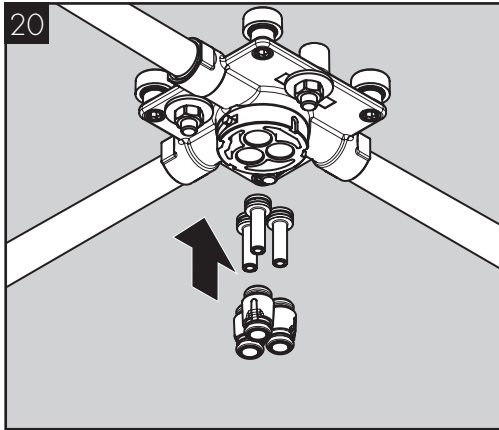
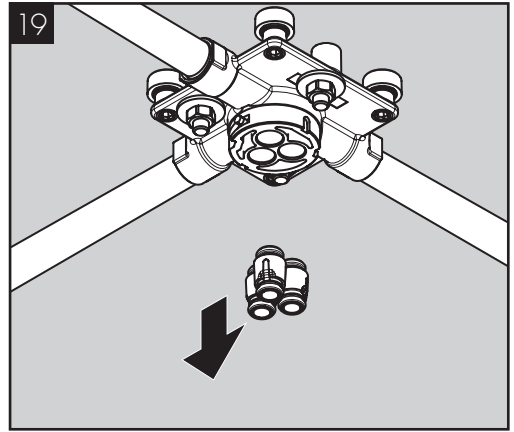
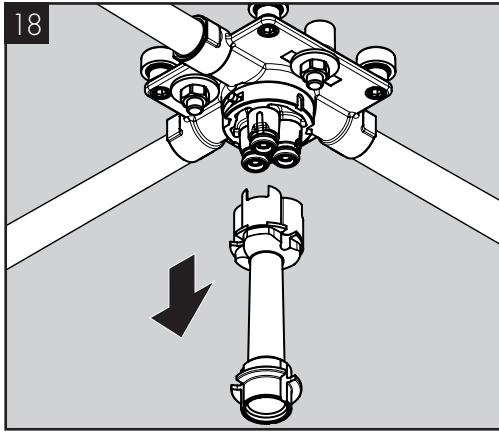

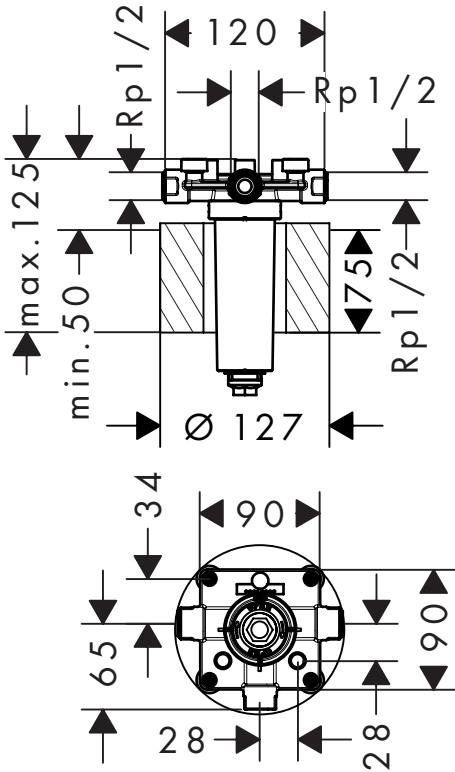
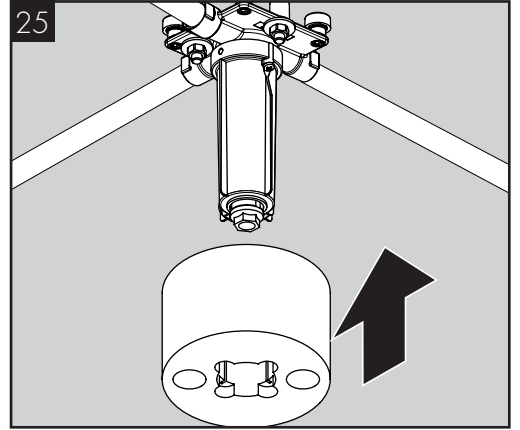
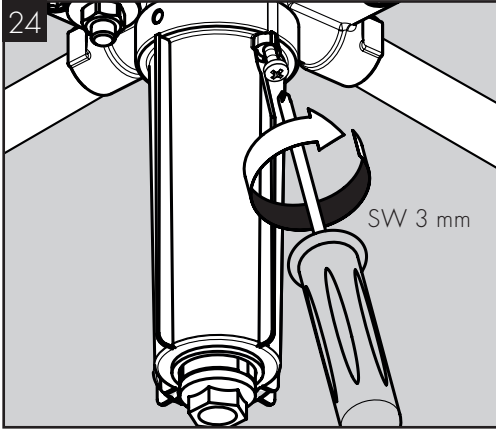

# AXOR

AXOR / Hansgrohe SE  
Austraße 5-9  
77761 Schiltach  
Deutschland

[info@axor-design.com](mailto:info@axor-design.com)  
[axor-design.com](http://axor-design.com)

03/2024  
911227.52