

AXOR One
45770187

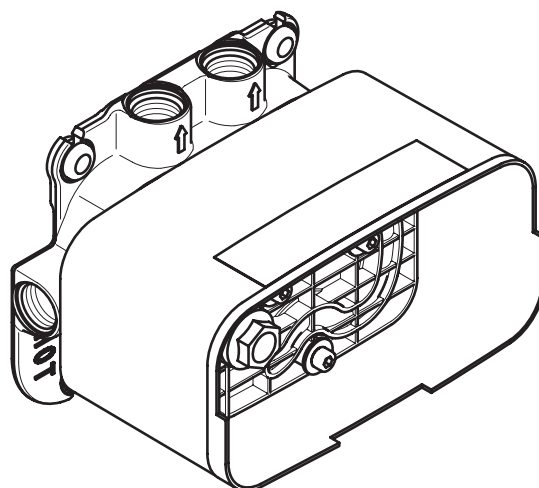

AXOR One
45710187

ZH / 用户手册 / 组装说明

02

EN / Instructions for use / assembly instructions

02

△ 安全技巧

- △ 装配时为避免挤压和切割受伤，必须戴上手套。
- △ 本产品只允许作为洗浴、卫生和洁身之用。
- △ 冷热水管间过大的压力差必须予以平衡。

安装提示

- / 安装前必须检查产品是否受到运输损害。安装后将不认可运输损害或表面损伤。
- / 管道和阀门必须根据通用标准进行安装、冲洗和检查。
- / 请遵守当地国家现行的安装规定。

工作压强:**推荐工作压强:****测试压强:****热水温度:****推荐热水温度:**

1 用户

2 用户

3 用户

1 + 2 用户

1 + 2 + 3 用户

4 额外的出水口

连接管线G 1/2:

热力消毒:

该产品专为饮用水设计！

最大 1 MPa

0,15 - 0,6 MPa

1,6 MPa

(1 MPa = 10 bar = 147 PSI)

最大 70°C

65 °C

大约 24 升/分钟

大约 24 升/分钟

大约 24 升/分钟

大约 30 升/分钟

大约 30 升/分钟

大约 29 升/分钟

左热右冷
最大 70°C / 4 分钟**△ SAFETY NOTES**

- △ Gloves should be worn during installation to prevent crushing and cutting injuries.
- △ The product may only be used for bathing, hygienic and body cleaning purposes.
- △ The hot and cold supplies must be of equal pressures.

INSTALLATION INSTRUCTIONS

- / Prior to installation, inspect the product for transport damages. After it has been installed, no transport or surface damage will be honoured.
- / The pipes and the fixture must be installed, flushed and tested as per the applicable standards.
- / The plumbing codes applicable in the respective countries must be observed.

Operating pressure:

max. 1 MPa

Recommended operating pressure:

0,15 - 0,6 MPa

Test pressure:

1,6 MPa

Hot water temperature:

(1 MPa = 10 bar = 147 PSI)

max. 70°C

Recommended hot water temp.:

65 °C

1 Consumer

approx. 24 l/min

2 Consumer

approx. 24 l/min

3 Consumer

approx. 30 l/min

1 + 2 Consumer

approx. 30 l/min

1 + 2 + 3 Consumer

approx. 30 l/min

4 Outlet for additional consumer

approx. 29 l/min

Connections G 1/2:

cold right - hot left

Thermal disinfection:

max. 70°C / 4 min

The product is exclusively designed for drinking water!

符号说明

请勿使用含有乙酸的硅胶！

大小
(参见第页 16)安装示意
(参见第页 03)中心淋浴盆 / 槽中间
(参见第页 03)备用零件
(参见第页 18)

Axor One与下水部件组合，配备出水组件及溢流组件 (参见第页 15)

Exafill

检验标记
(参见第页 20)**SYMBOL DESCRIPTION**

Do not use silicone containing acetic acid!

DIMENSIONS
(see page 16)INSTALLATION EXAMPLE
(see page 03)CENTER SHOWER TUB / CENTER BATH TUB
(see page 03)SPARE PARTS
(see page 18)Axor One in combinaton with an Exafill bath filler with overflow and waste
(see page 15)

Exafill

TEST CERTIFICATE
(see page 20)

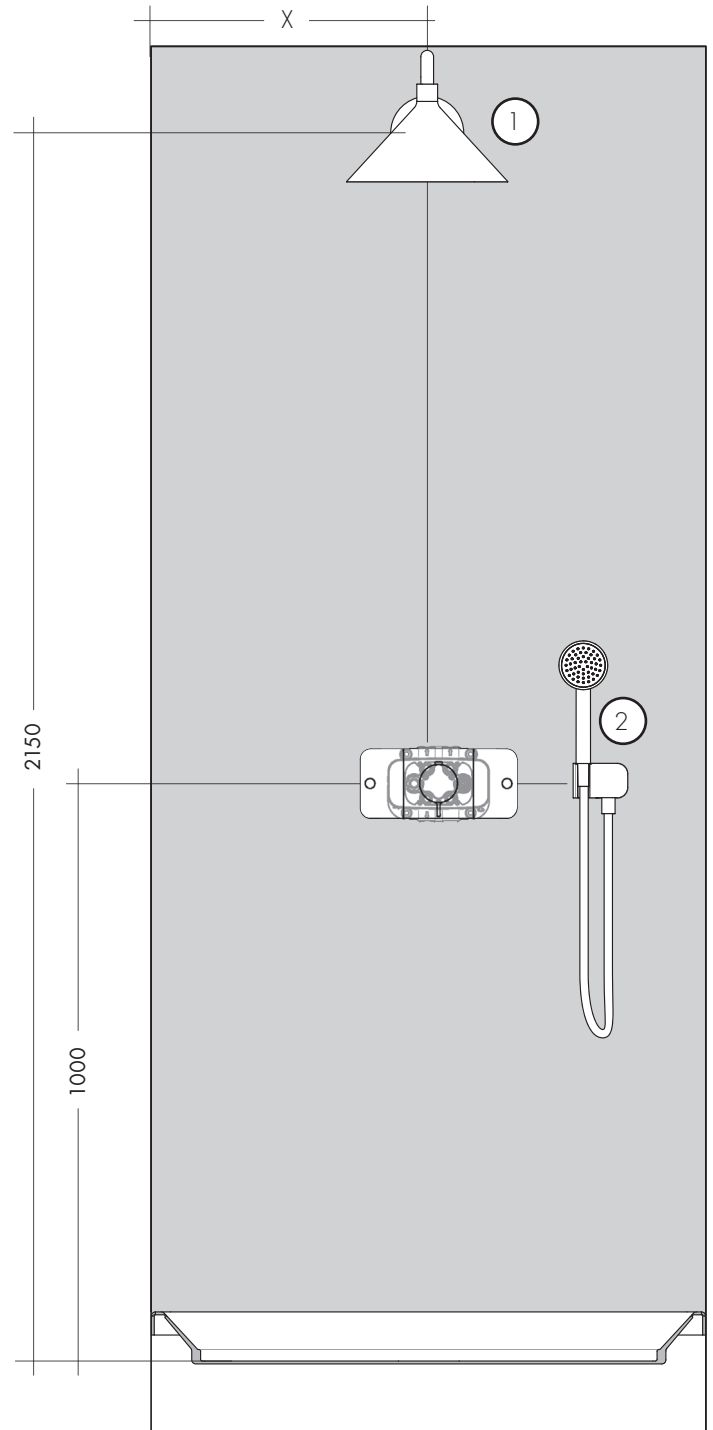
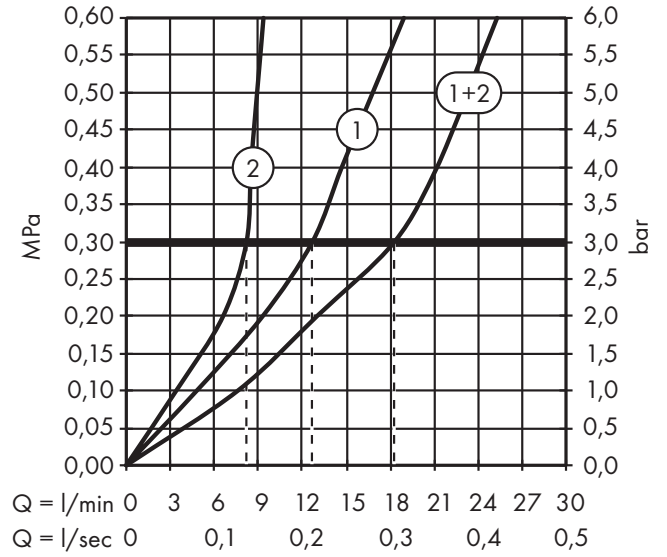
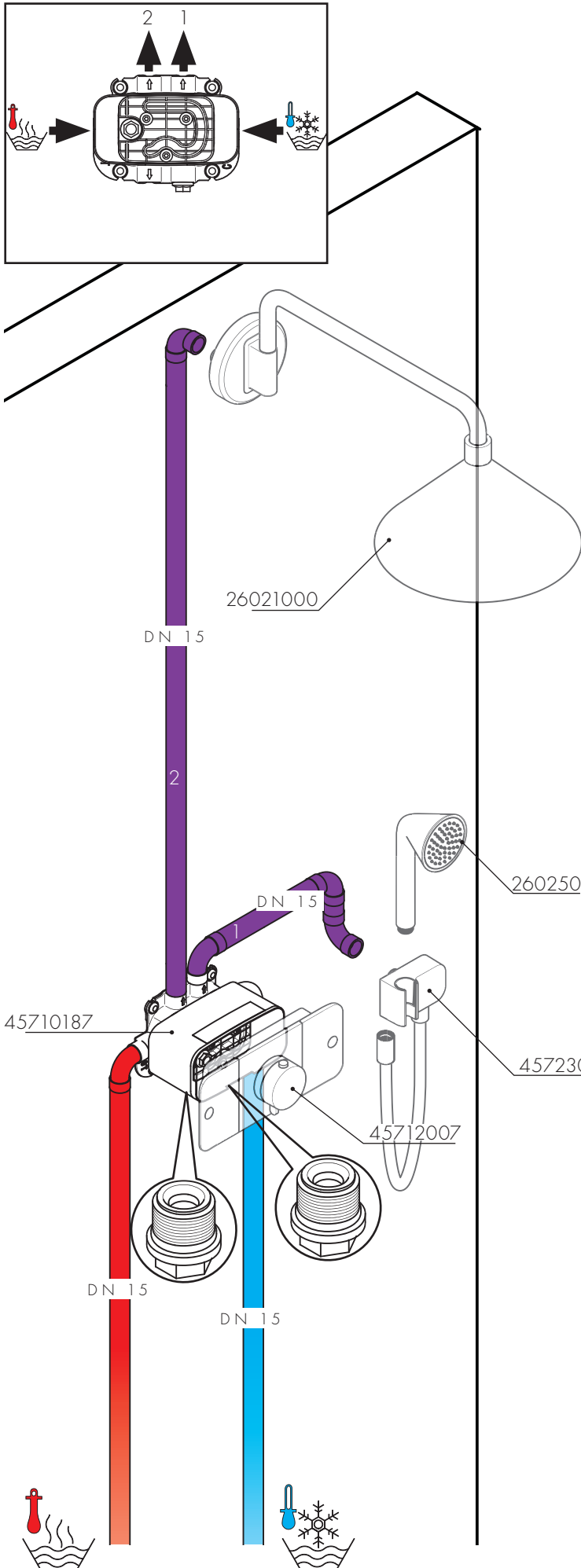

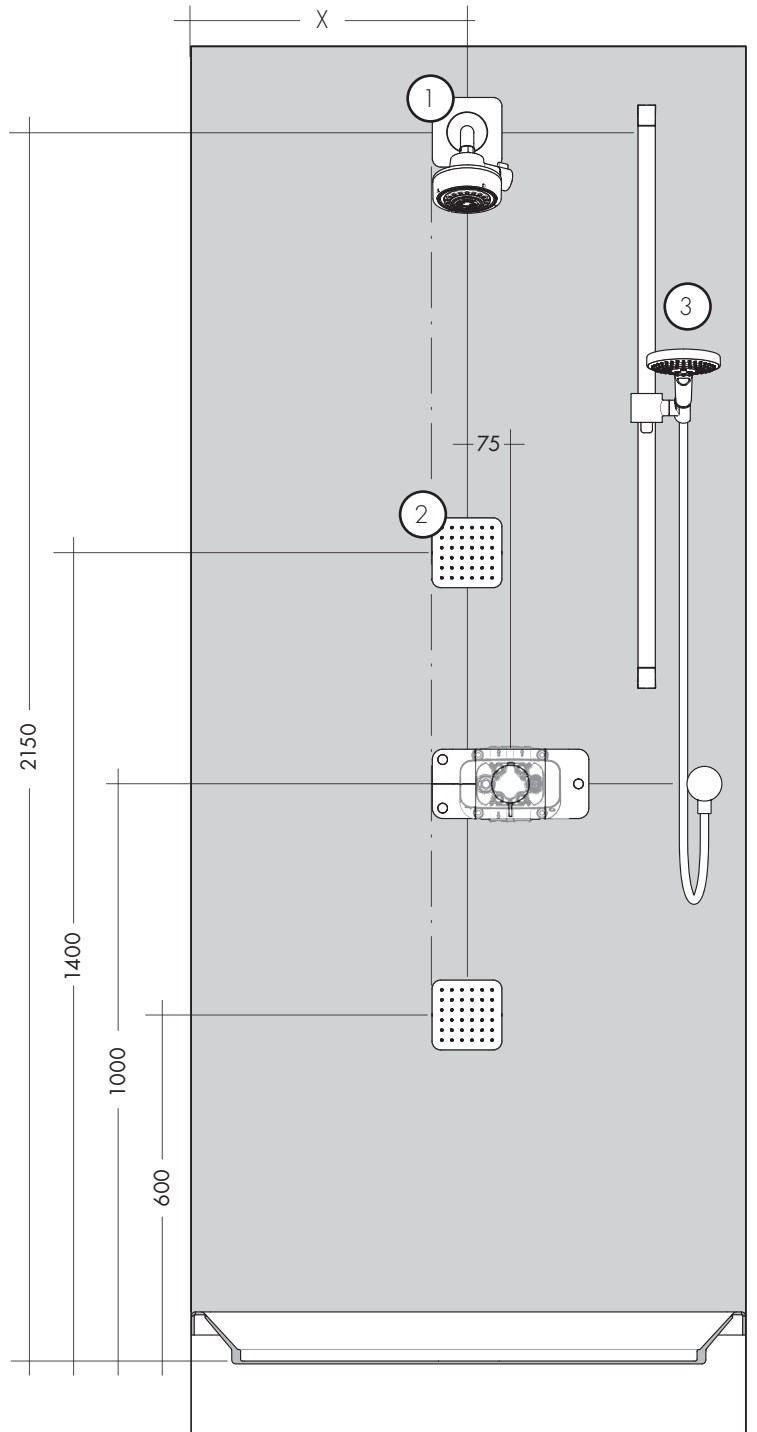
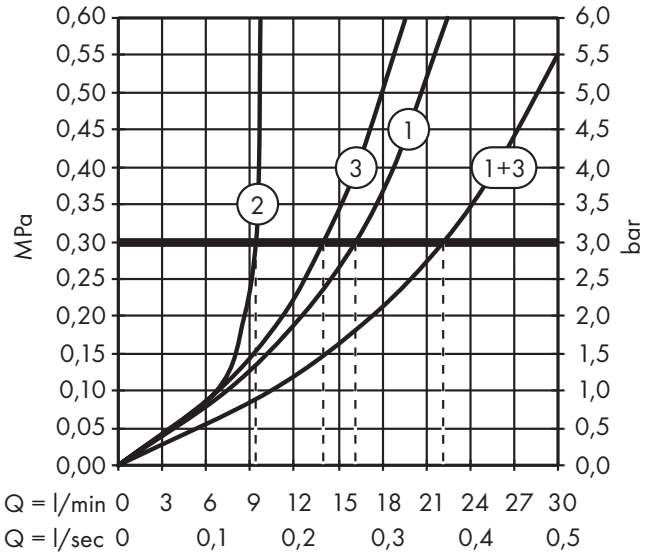
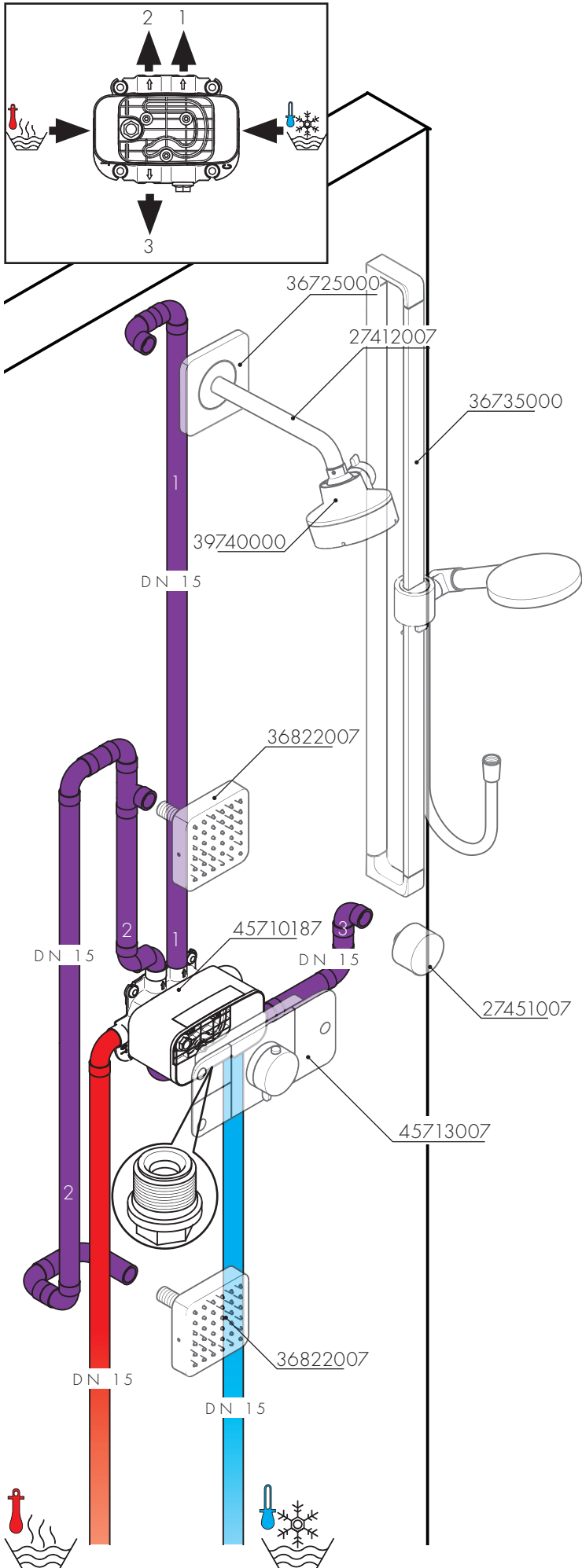

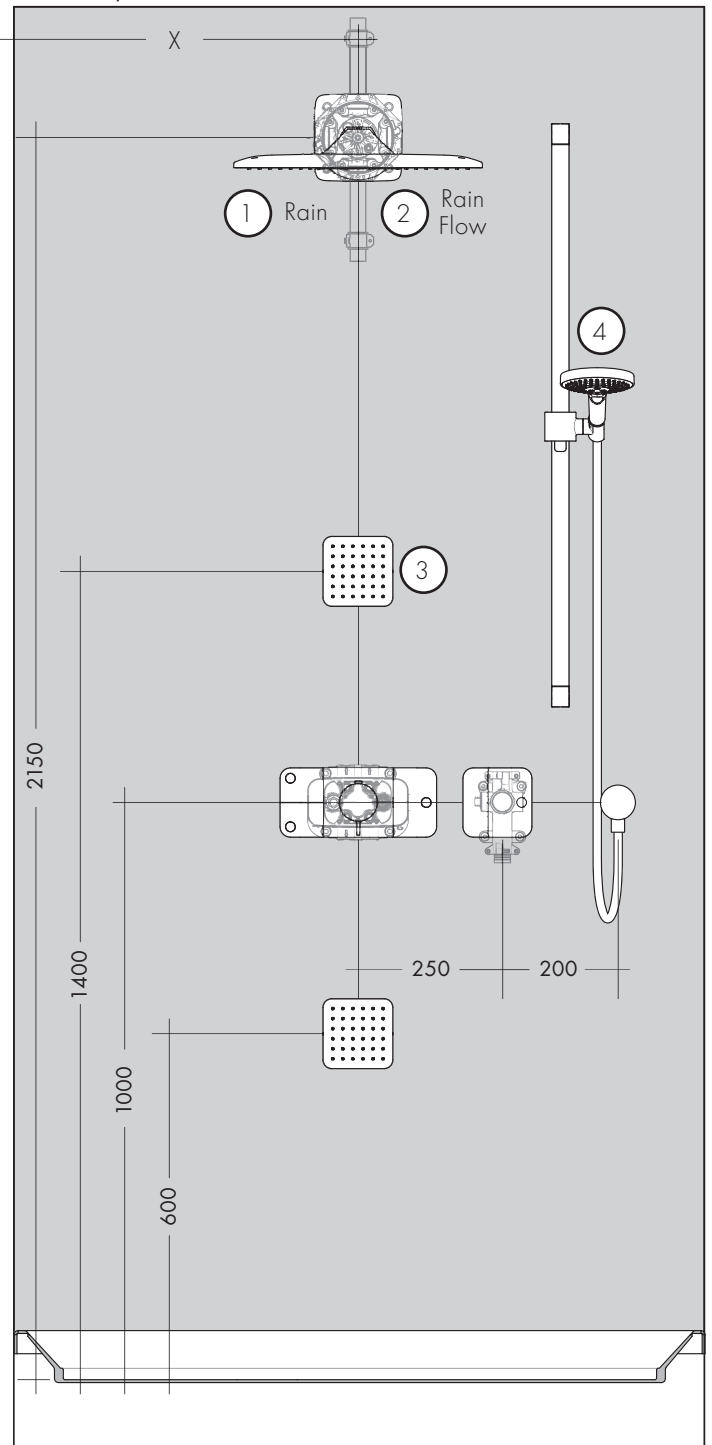
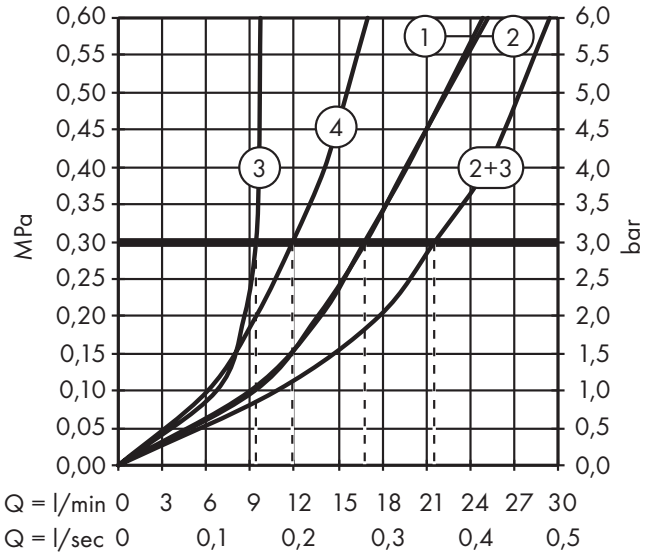
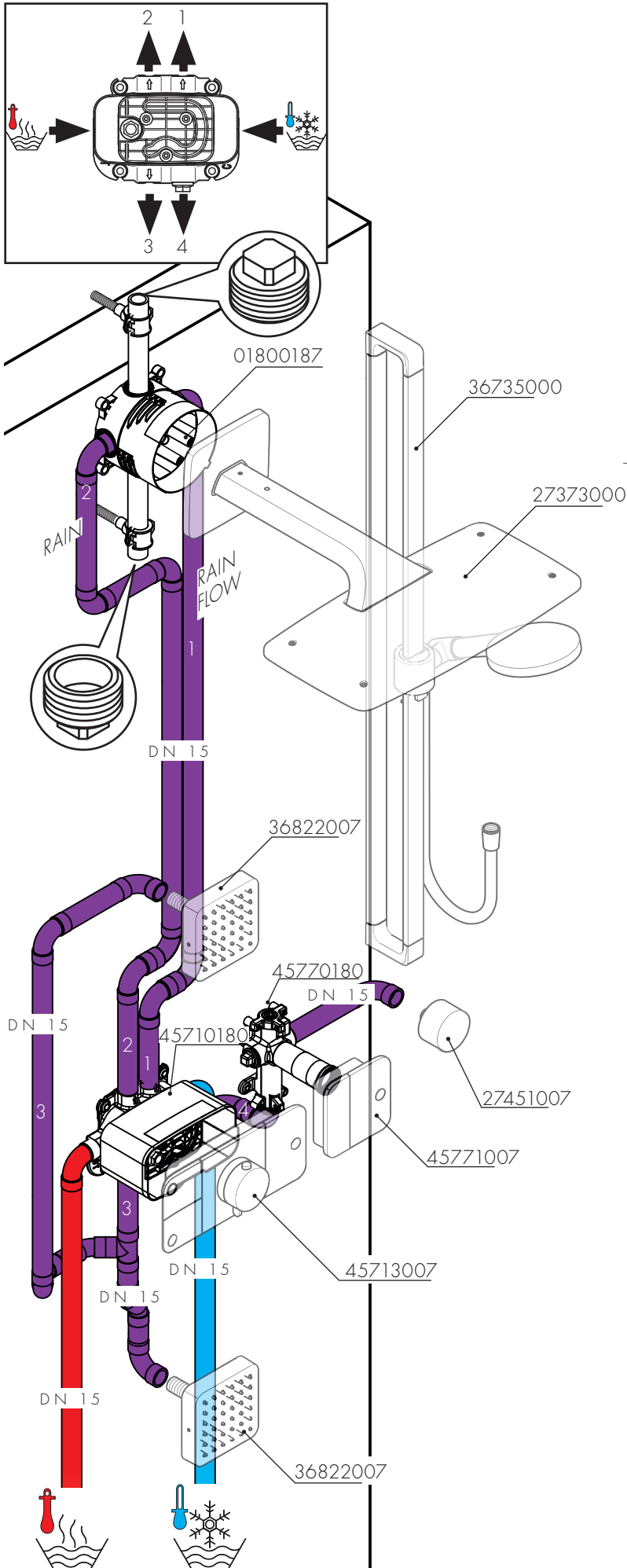

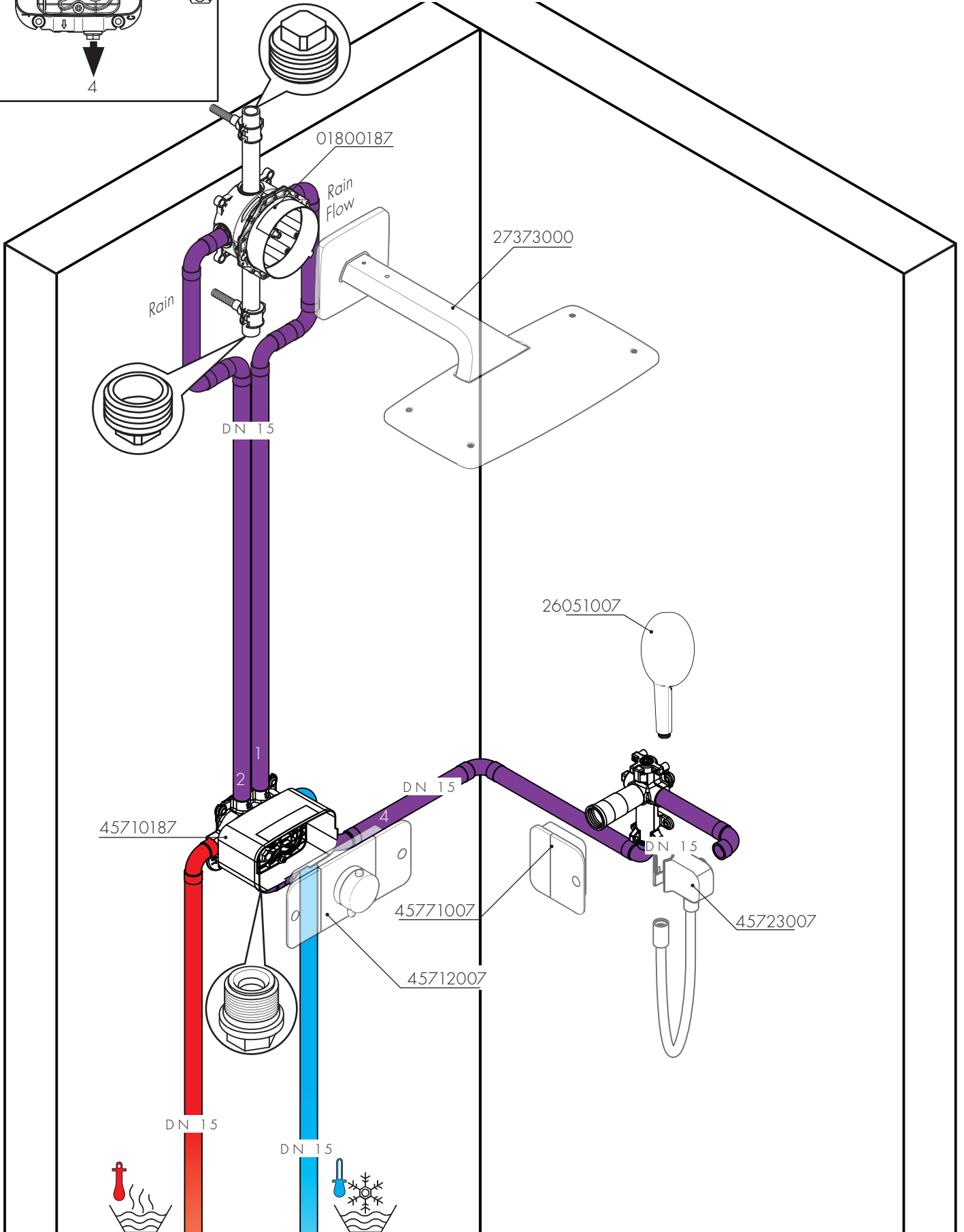
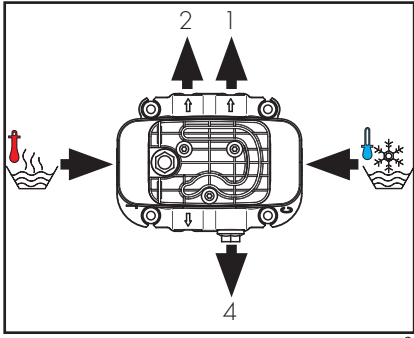

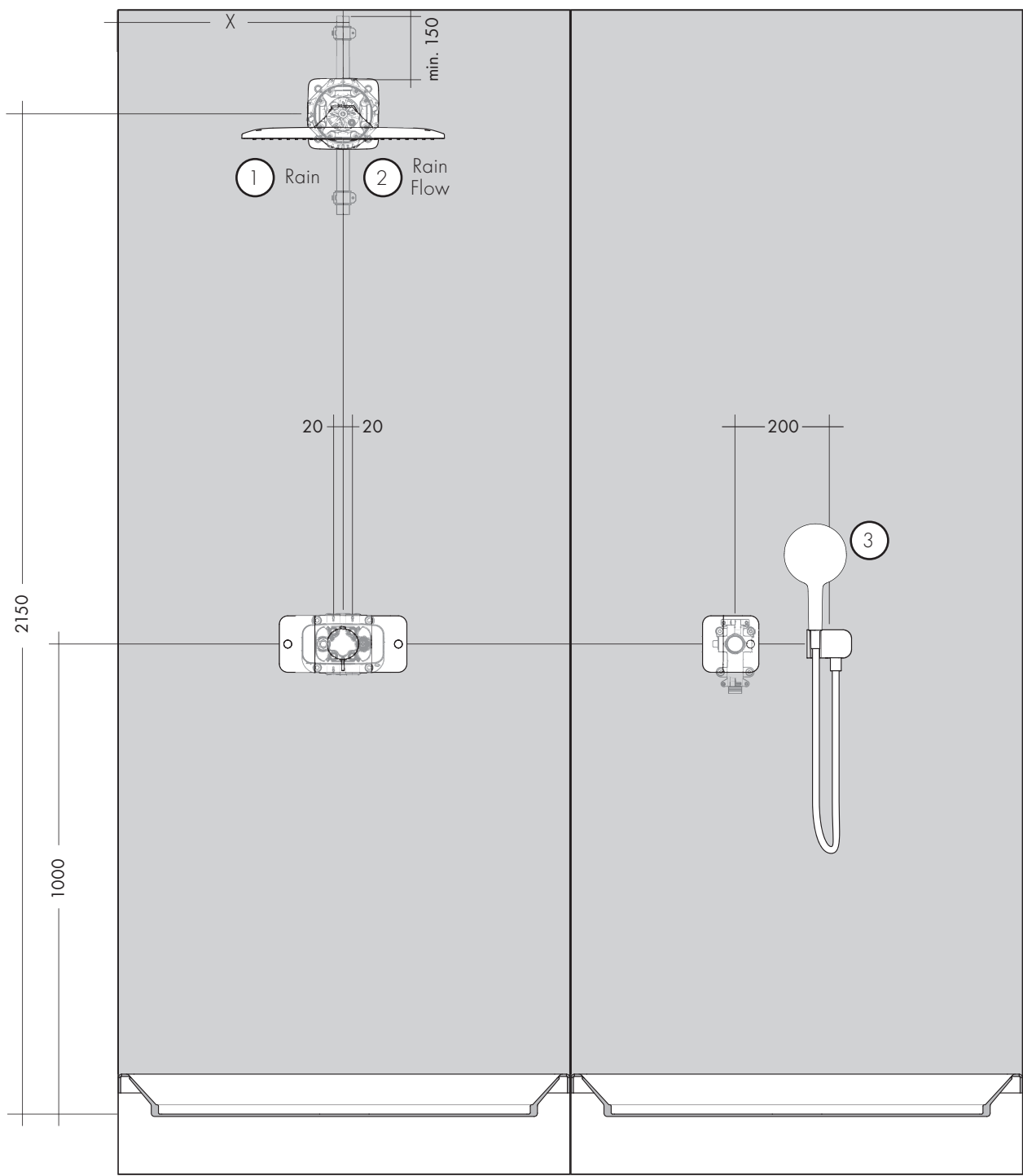
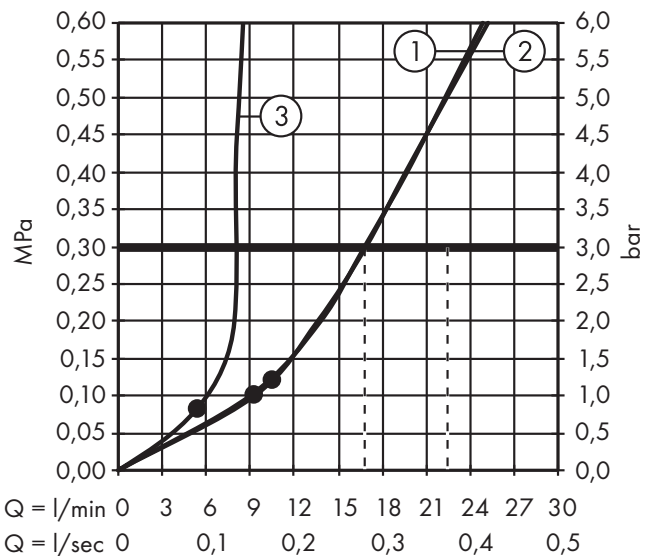

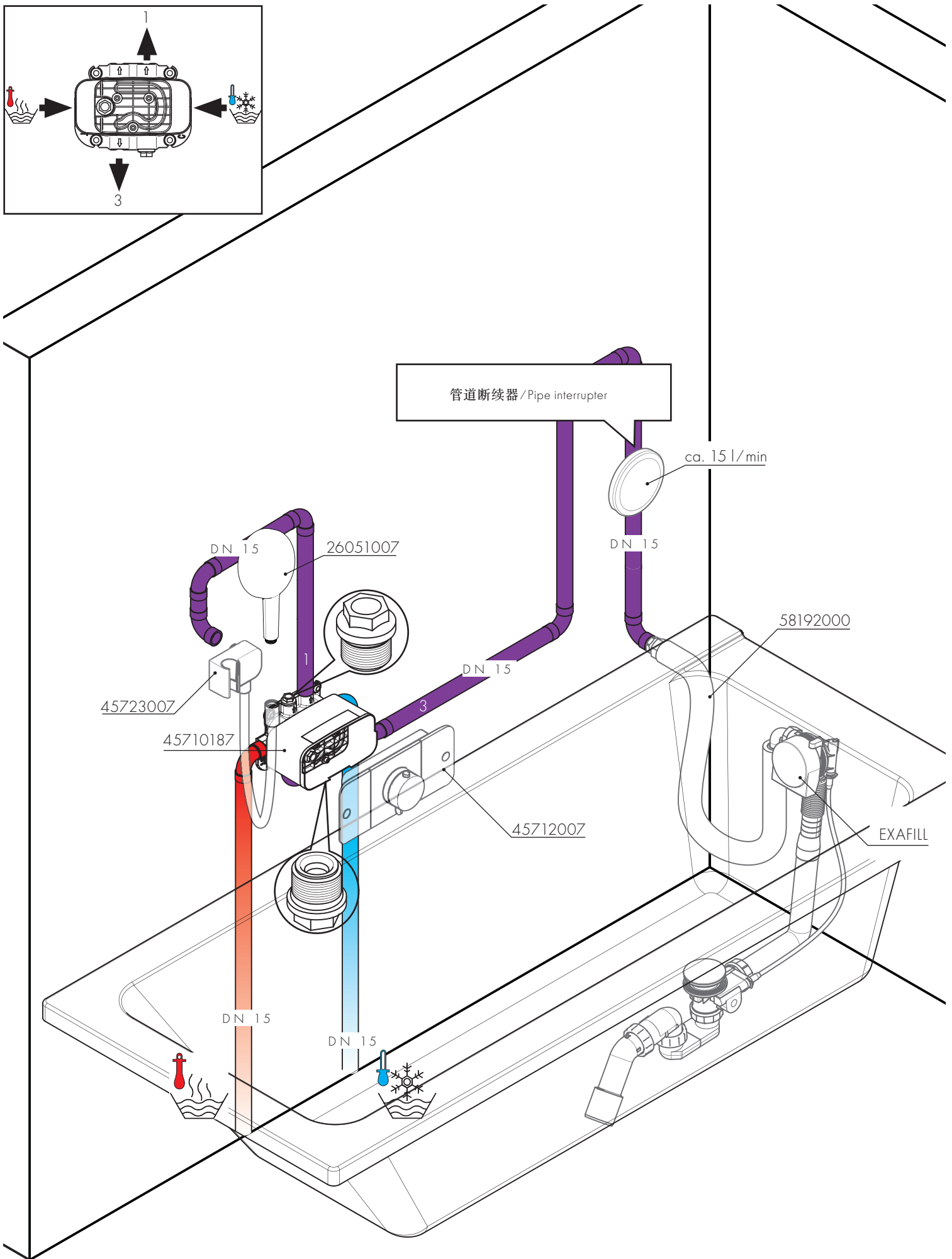
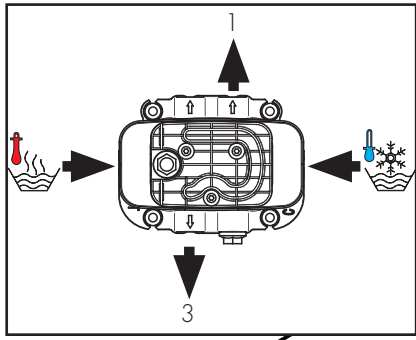

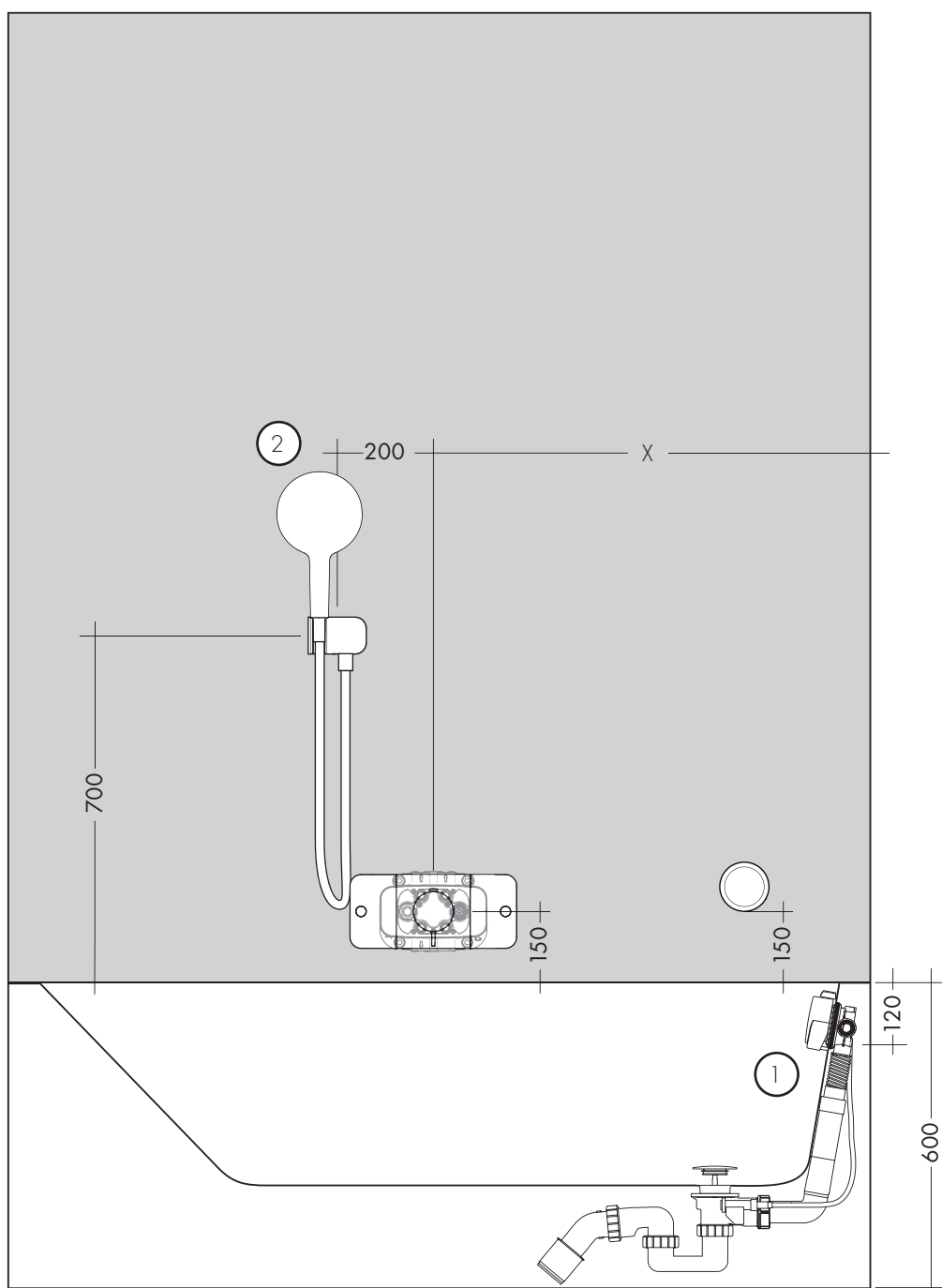
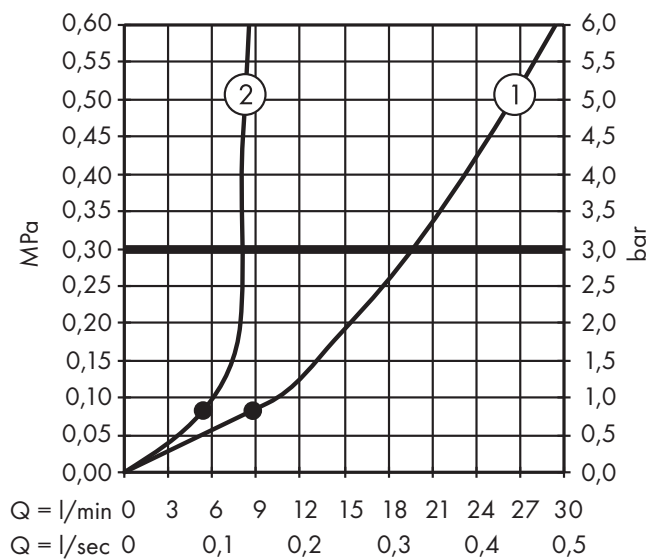



1

中文

将已经安装并经过检验的基体抹灰，或者在安装前壁时用壁覆面系统将其包覆。已抹灰的壁表面干燥后，使用硅胶（不含醋酸）对壁与塑料外壳之间的接缝点进行喷塑。

ENGLISH

Plaster the installed and tested basic components, or cover with panelling if installed on the exterior of the wall. After the plastered wall surface has dried, fill the seam between the wall and the plastic housing with silicone (free of acetic acid).

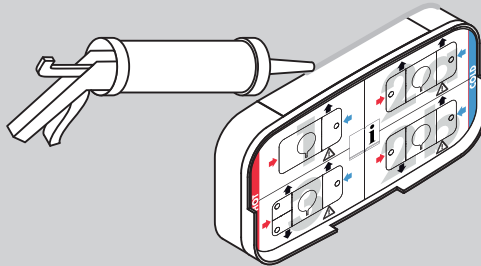

2

遵照制造商的说明，在边壁上使用PCI胶黏层或类似的密封材料。

Apply PCI-Lastogum or similar sealing compound on the wall in accordance with manufacturers indications.

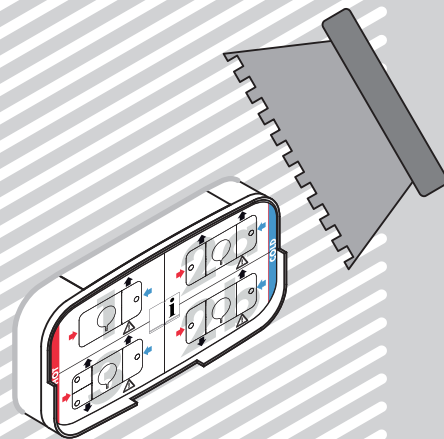

3

锯开密封涨圈。

指示说明！ 密封涨圈不可重叠。

将密封圈套到塑料外壳上并压到胶水和硅胶中。

Cut sealing collar to size

NOTE! SEALING COLLARS MUST NOT OVERLAP PLACE A SEALING COLLAR OVER THE PLASTIC HOUSING AND PRESS IT INTO THE GLUE AND THE SILICONE.

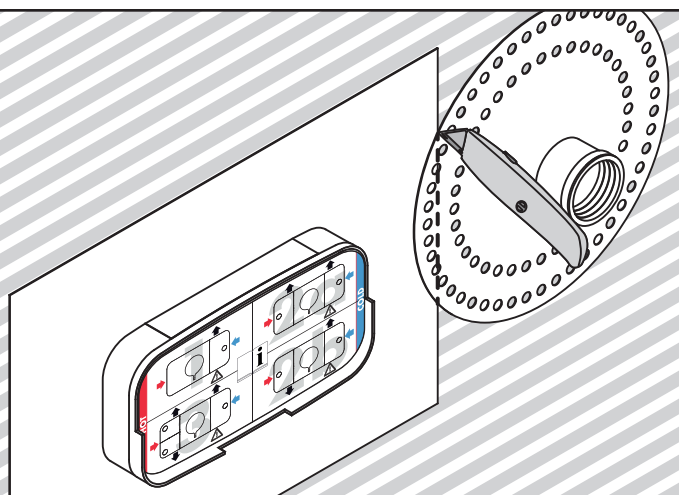

4



注意！ 不能热粘贴密封涂层。

IMPORTANT! THE GASKET IS NOT SUITABLE FOR HOT GLUE.

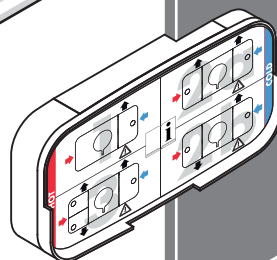

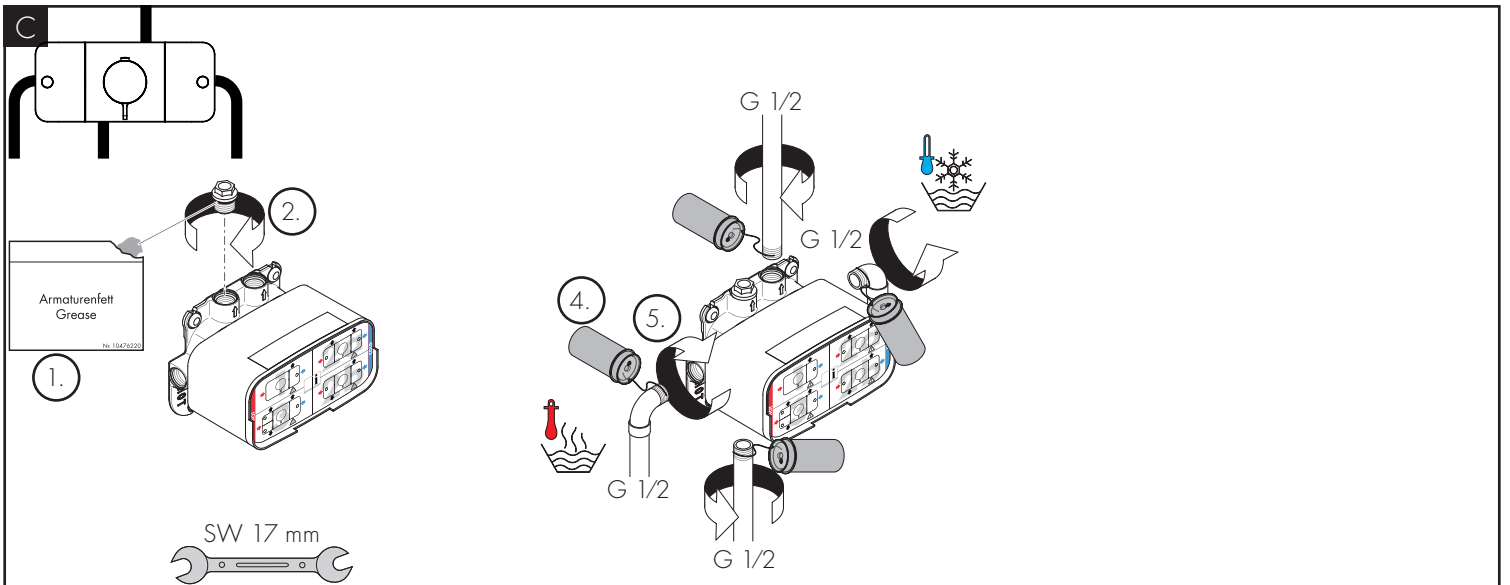
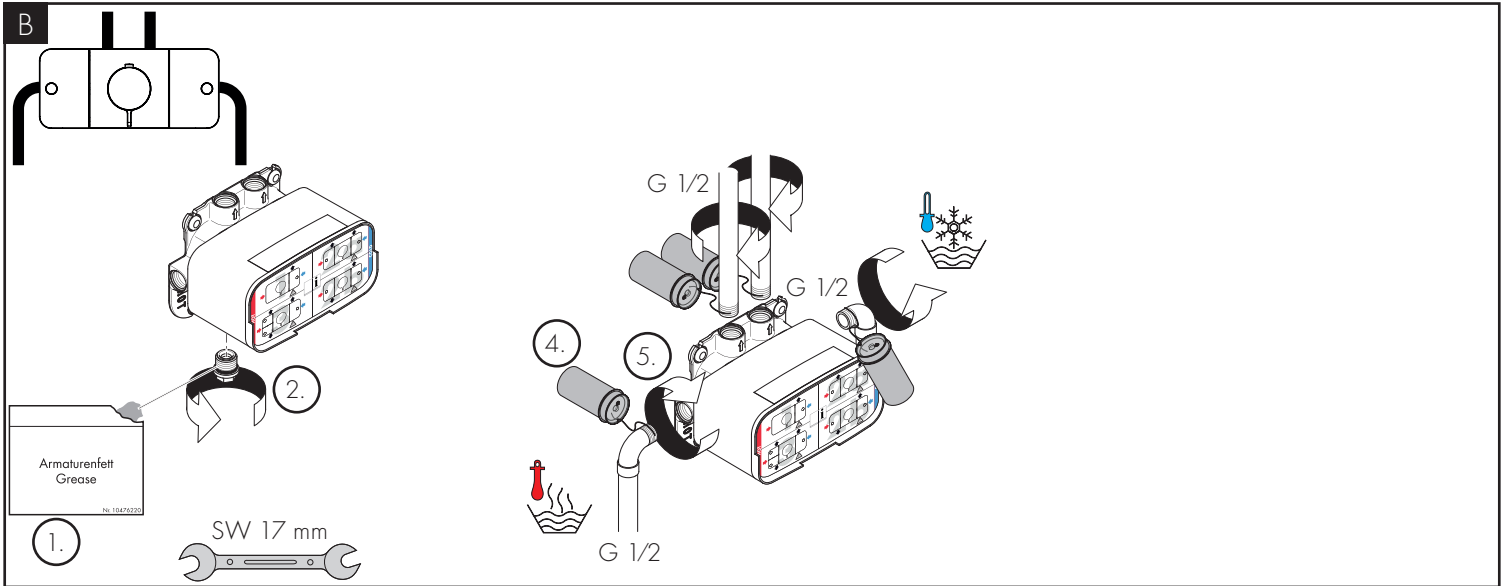
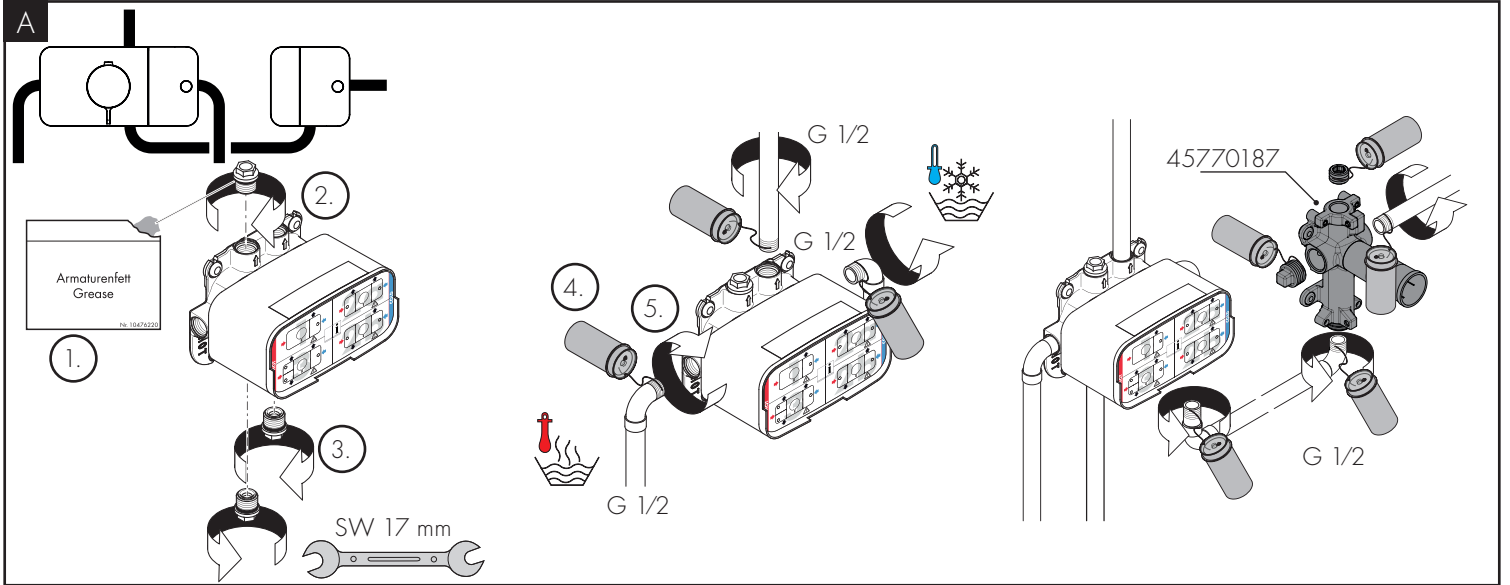

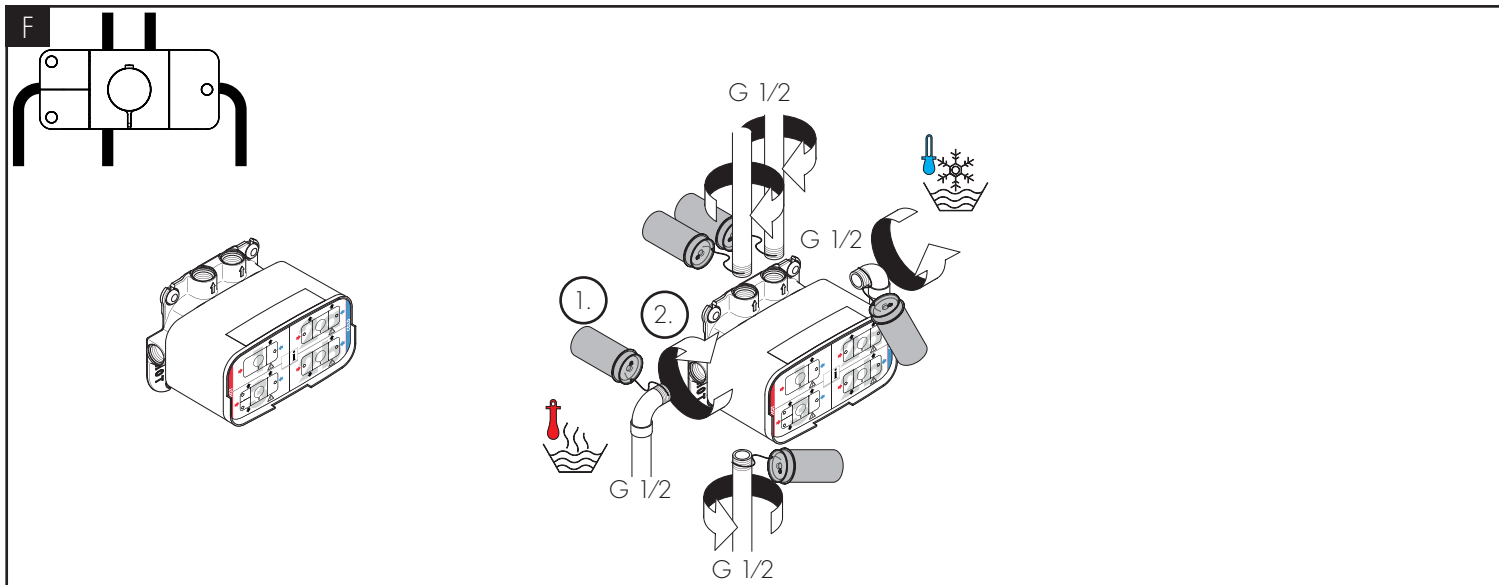
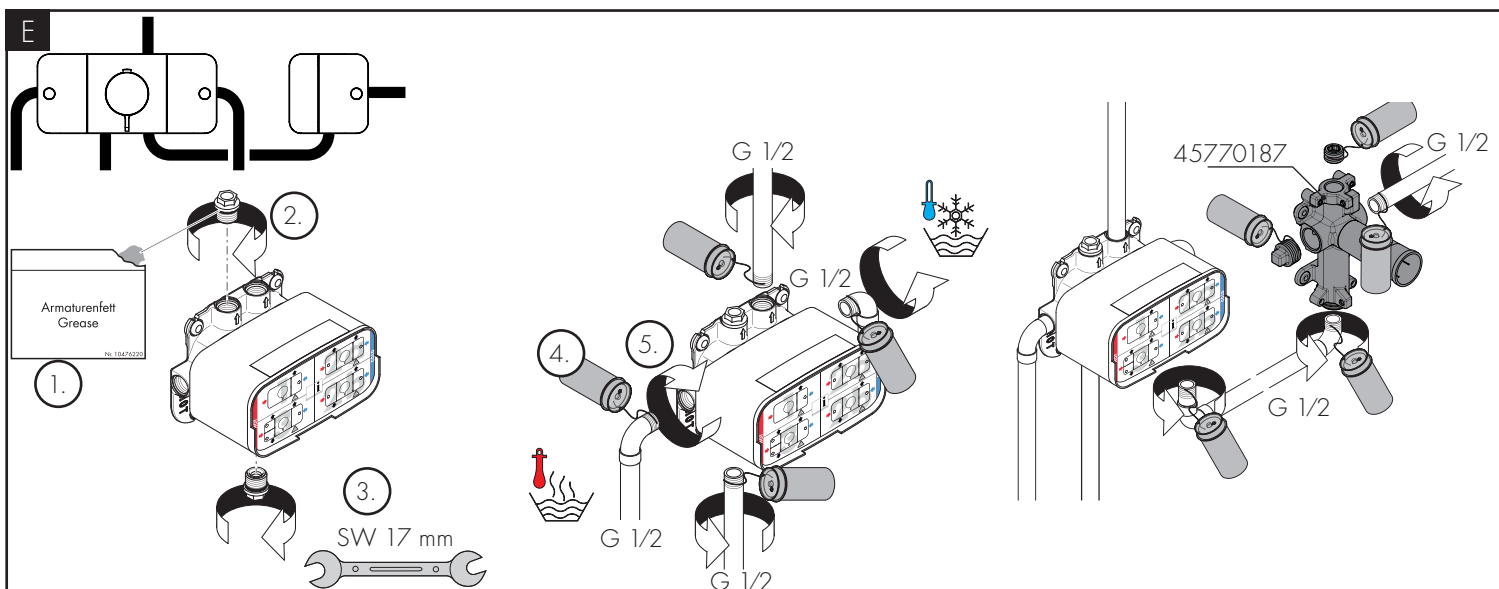
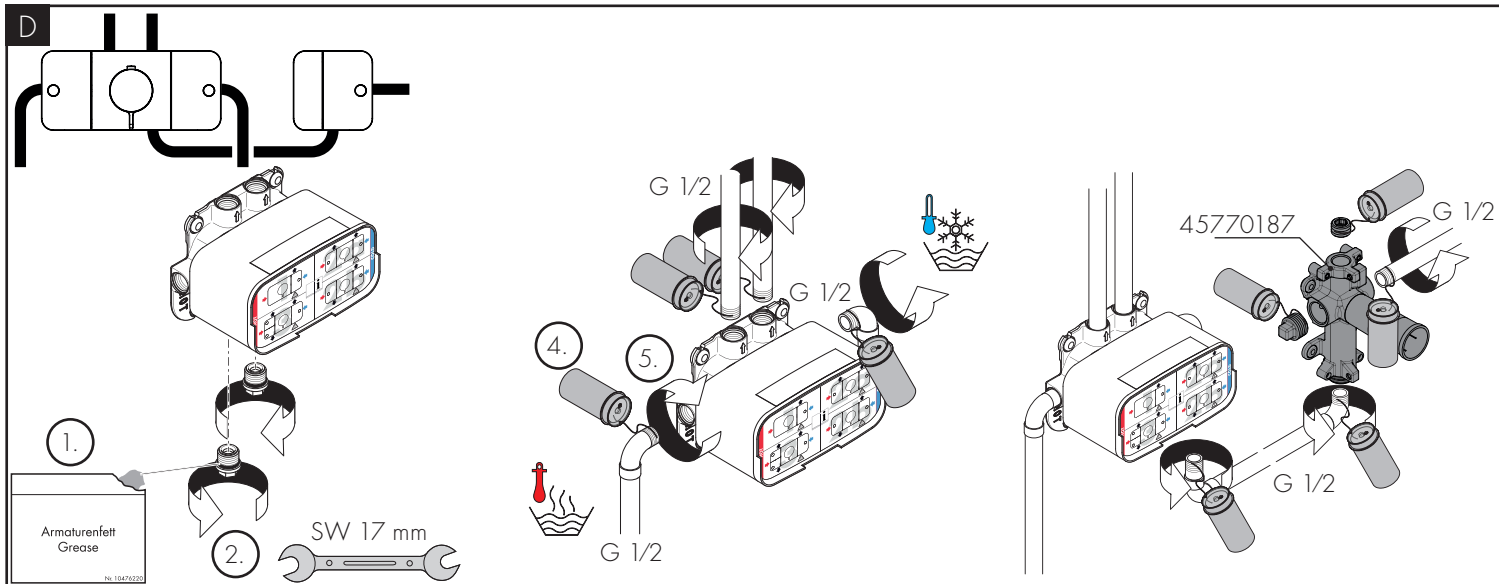

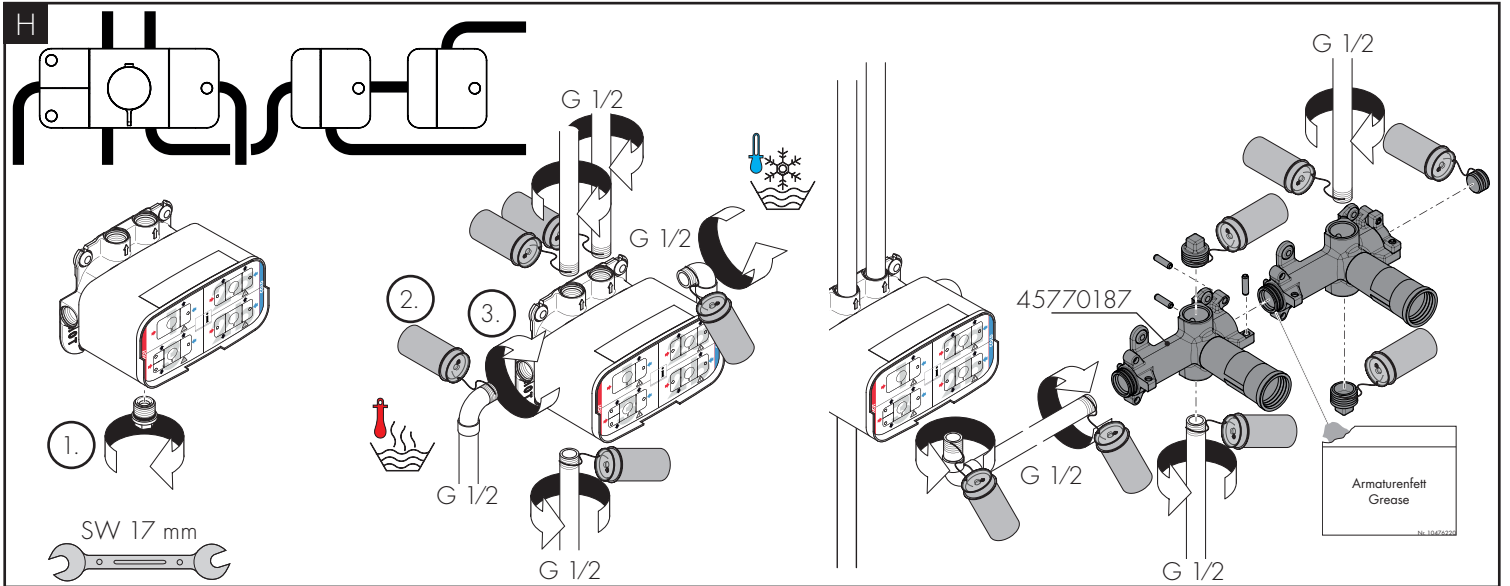
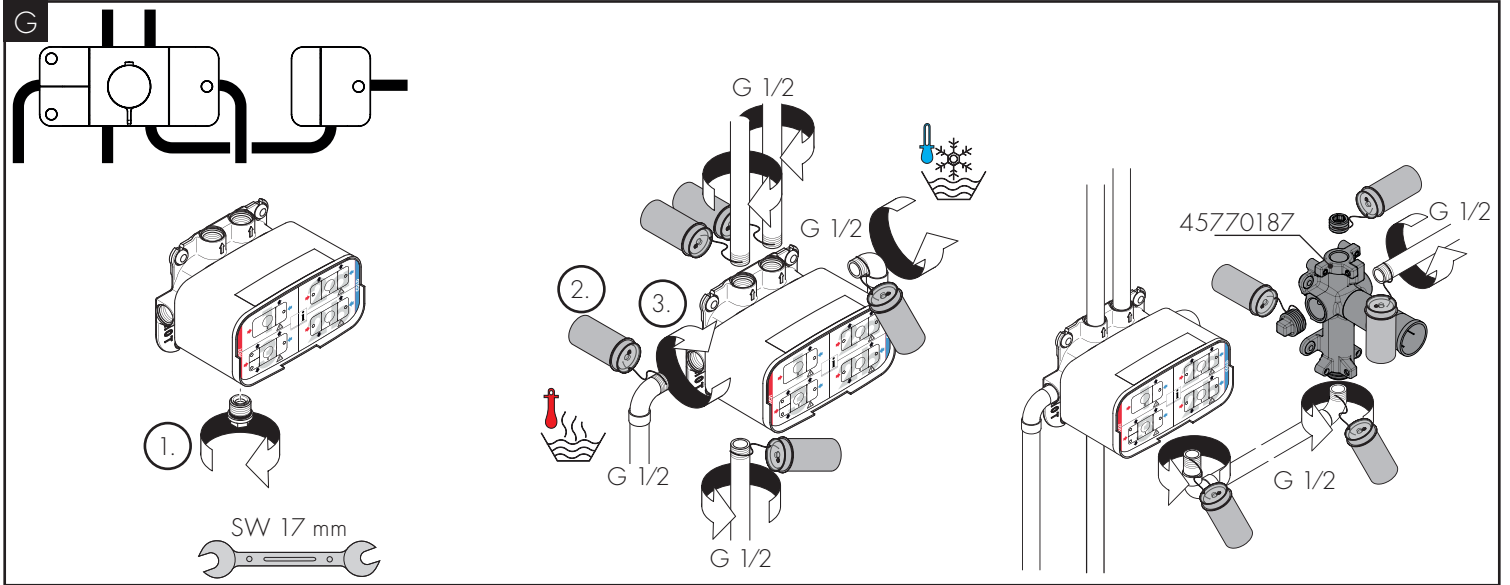

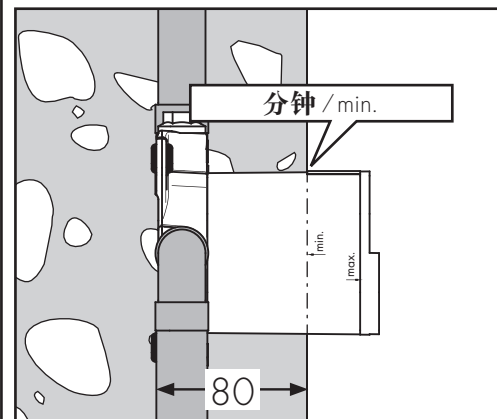
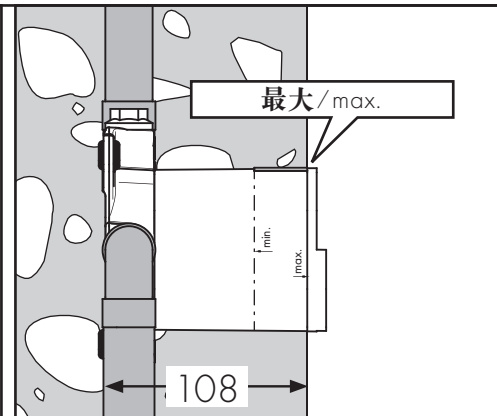
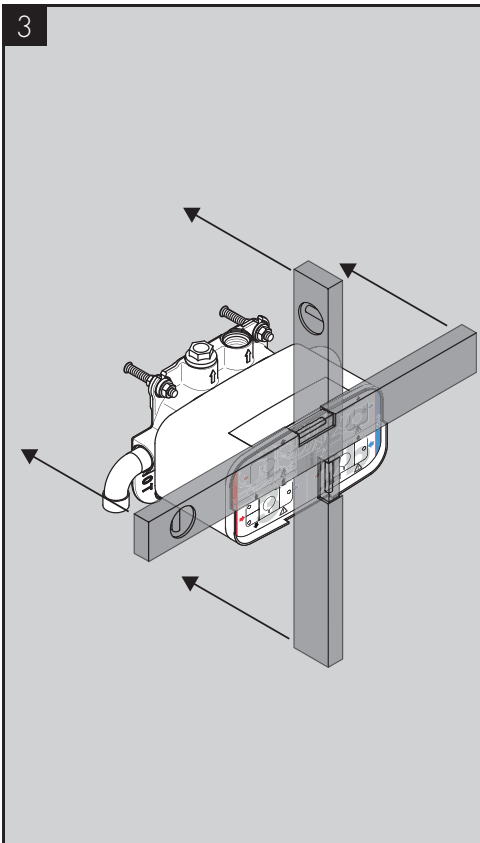
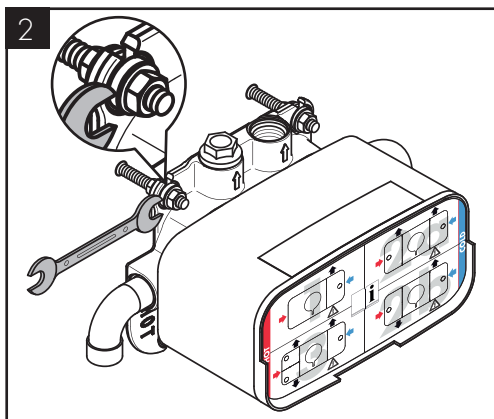
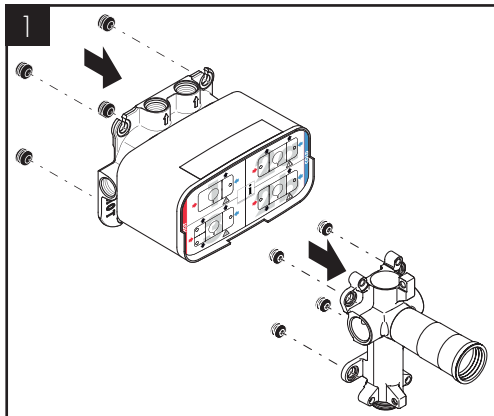

4a

ZH / 冲洗管道.
EN / Flushing of the pipes.

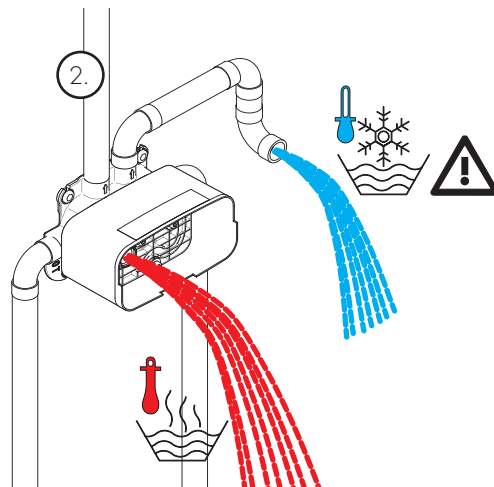
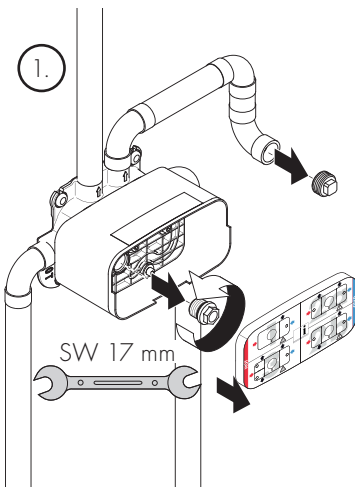

4b

ZH / 冲洗管道.
EN / Flushing of the pipes.

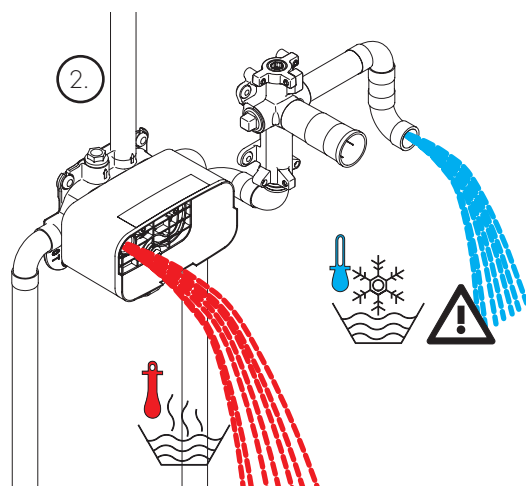
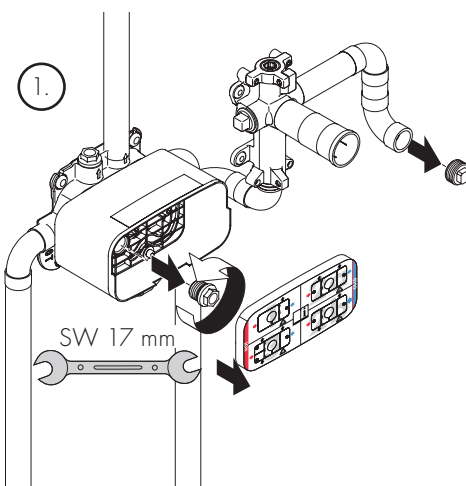

AXOR One + Exafill

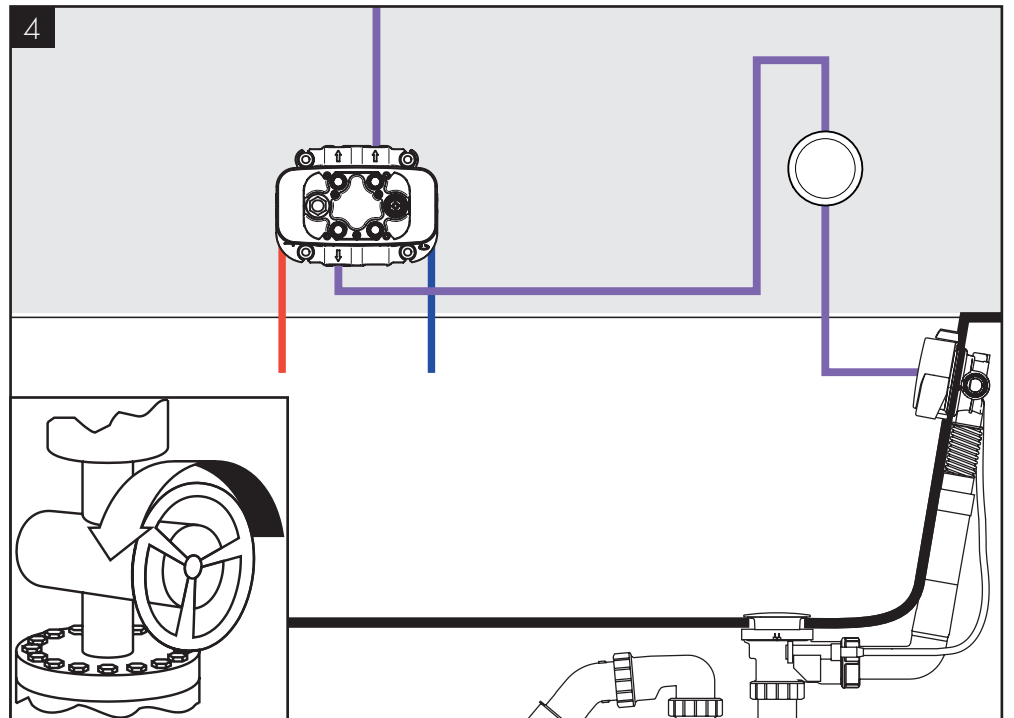
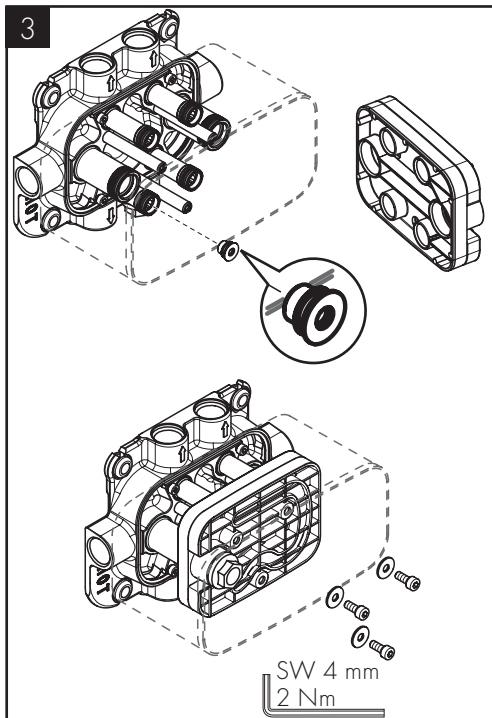
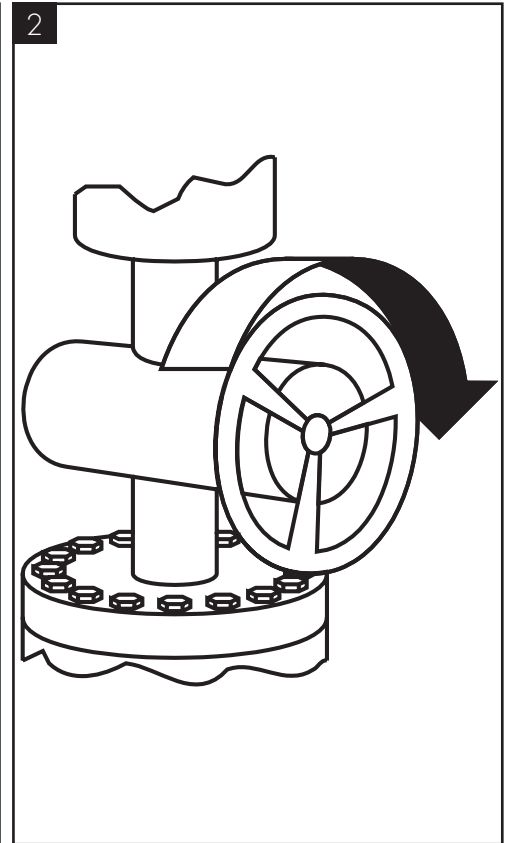
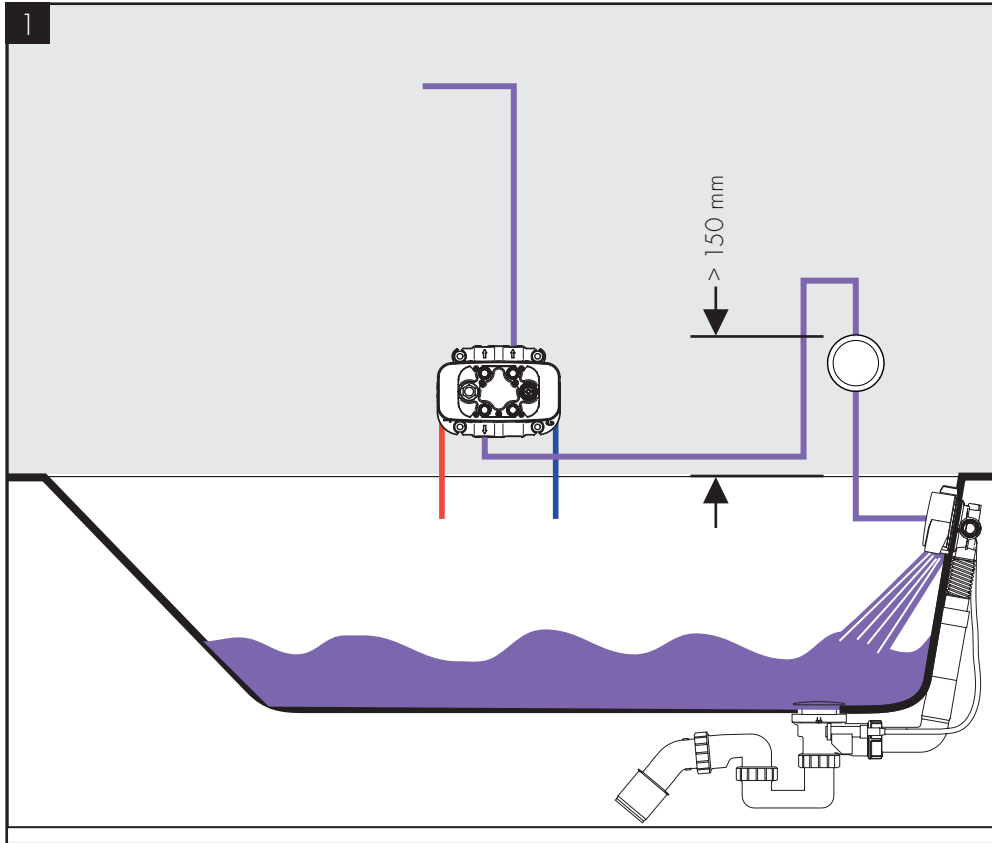
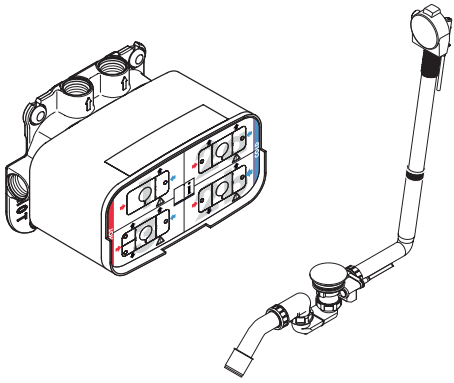



AXOR One
45710187

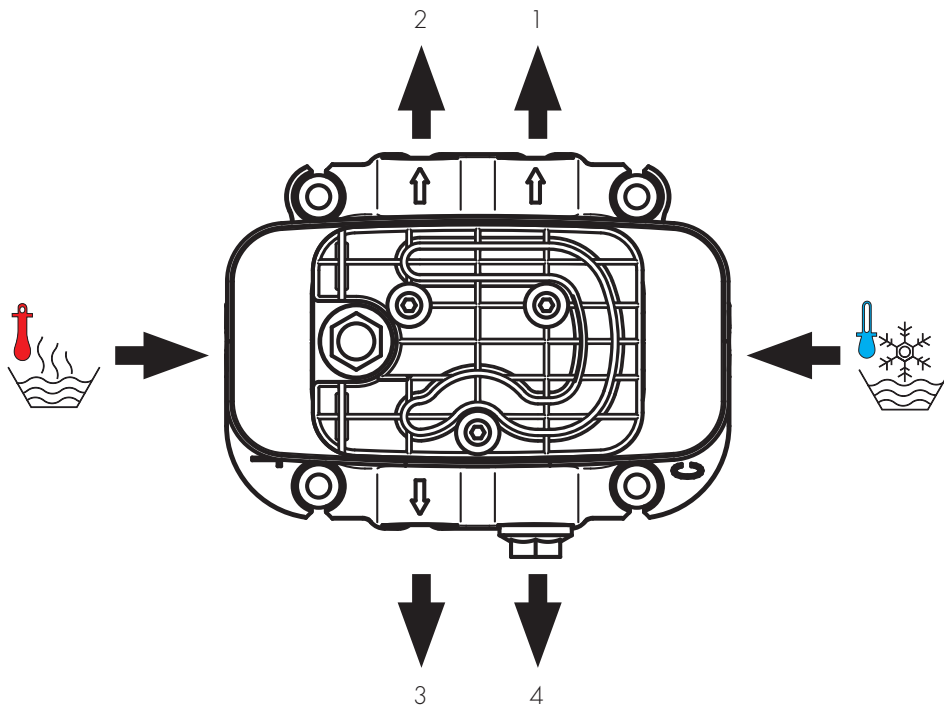
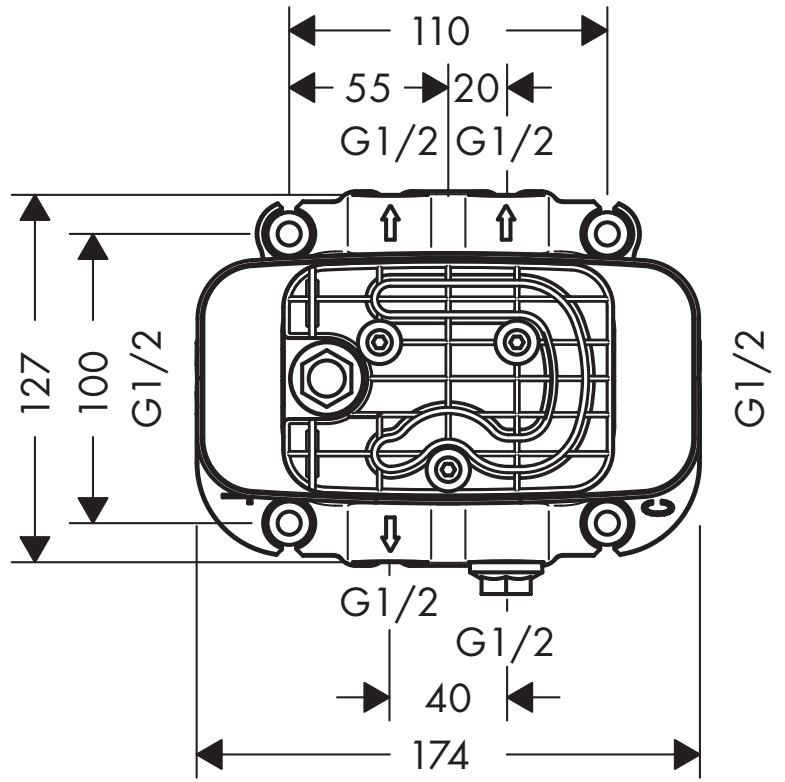
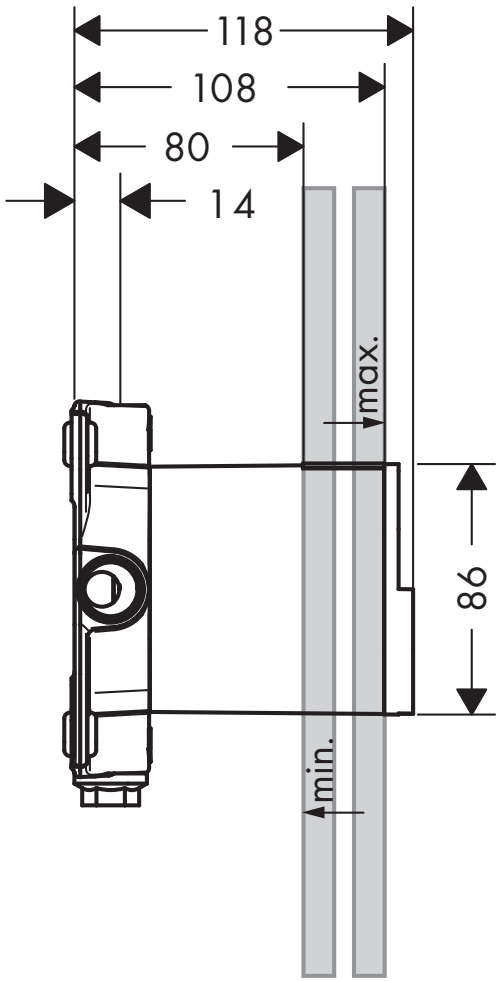



AXOR One
45770187

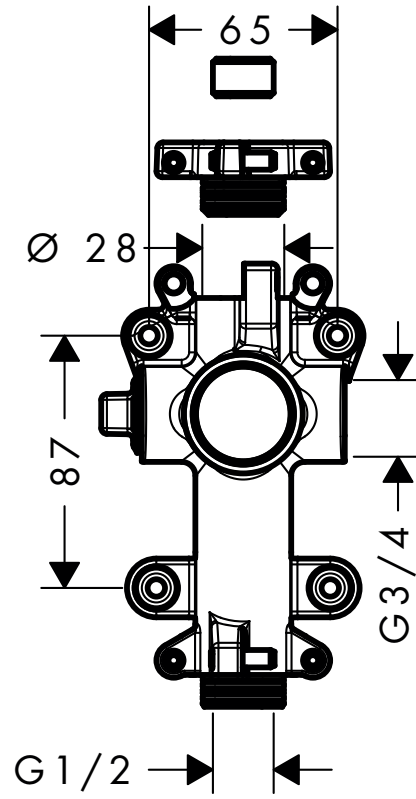
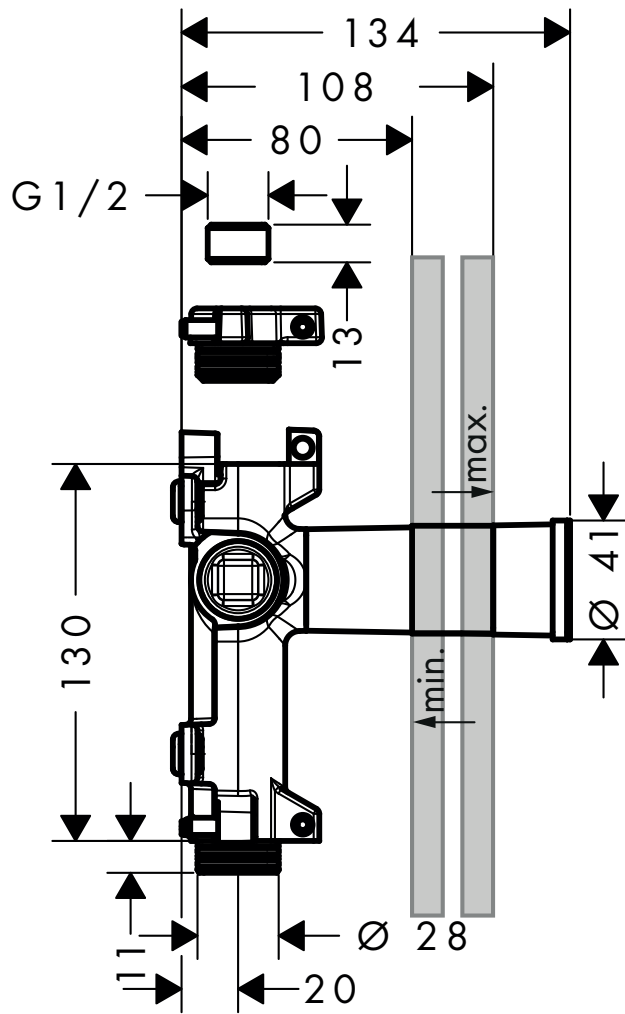



AXOR One
45710187

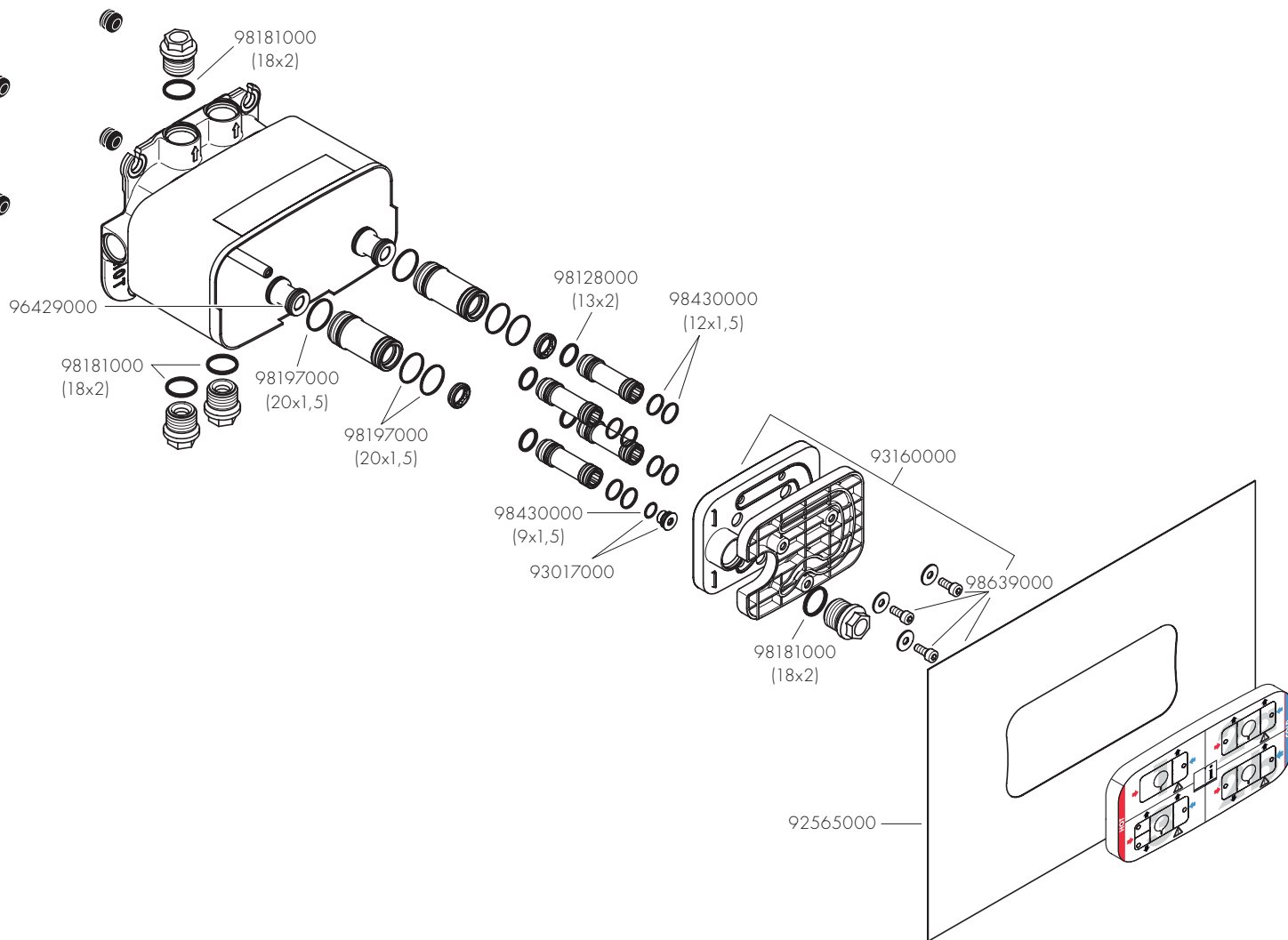

AXOR One
45770187

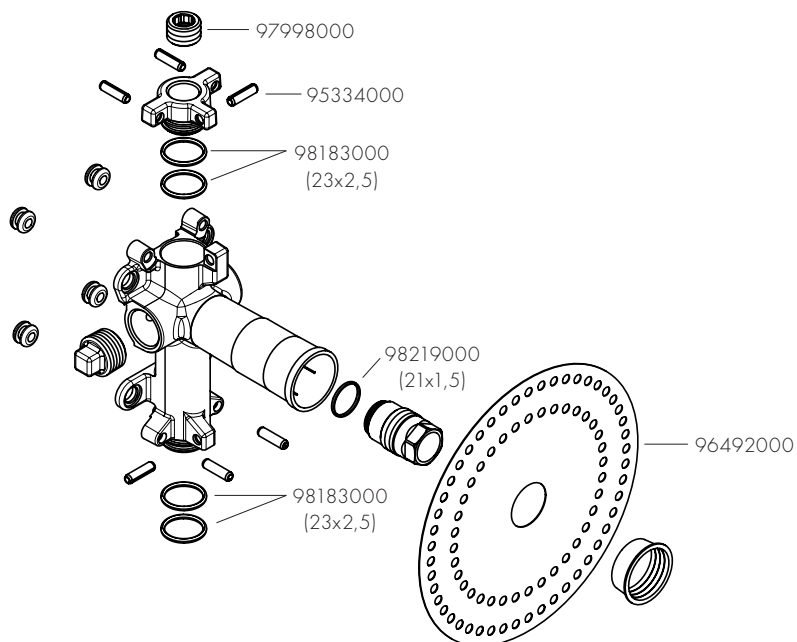

AXOR

AXOR / Hansgrohe SE
Austraße 5-9
77761 Schiltach
Deutschland

info@axor-design.com
axor-design.com

09/2017
9.02954.51