

AXOR



AXOR CITTERIO
PLANNING IDEA – BATHROOM 14M²



S H A N G H A I

THE CITY OF THE FUTURE, IN PROGRESS TODAY

China's most cosmopolitan city, Shanghai is growing at an electrifying pace, not only in size but in prestige and global influence. Indeed, the city is positioned to become a, if not the, leading world metropolis by 2035. In pursuit of this ambition, the local government has created what may be the largest city-wide development plan ever implemented. Although it aims to cap population at current levels and limit overall construction, Shanghai Master Plan 2035 is not about constraining growth so much as creating new possibilities. With a focus on building "a place full of positive energy and vitality," where people can "jog in green spaces close to their homes" and sit on the grass "to watch birds fly by", the plan offers a roadmap to an innovative and sustainable metropolis that prioritizes quality of life. Shanghai has already developed a reputation for attracting the world's leading architects and bringing their most ambitious ideas to fruition. With its new master plan in place, the world's third largest city is destined to become a global epicenter of Compact Luxury.



INTERNATIONAL ELEGANCE:
AN AXOR CITTERIO BATHROOM
WITH A RICH MATERIAL MIX
AND A WARM, WELCOMING
AESTHETIC.

Exemplifying the principles of Compact Luxury, the AXOR 'Contemporary Natural (M)' concept brings a sense of luxurious spaciousness to a mid-sized bathroom. The design is characterized by its efficient use of space, with the bathtub positioned against the wall in a classical installation. The window, although not large, allows ample natural light while offering an exceptional view of the city.

A CALMING BALANCE OF ELEMENTS.

A floor-to-ceiling window floods the bathroom with natural light. The monolithic washbasin made of natural stone, offers plenty of storage space. At the washbasin a 3-hole basin mixer with classic cross handles is mounted. A 3-hole wall-mounted bathtub mixer with cross handles and plate is used on the wood bathtub made of Palisander. All fittings are, like the AXOR products in the shower, in classic chrome, which matches the warm, dark color palette of the bathroom.



AXOR CITTERIO BATHROOM 14M²

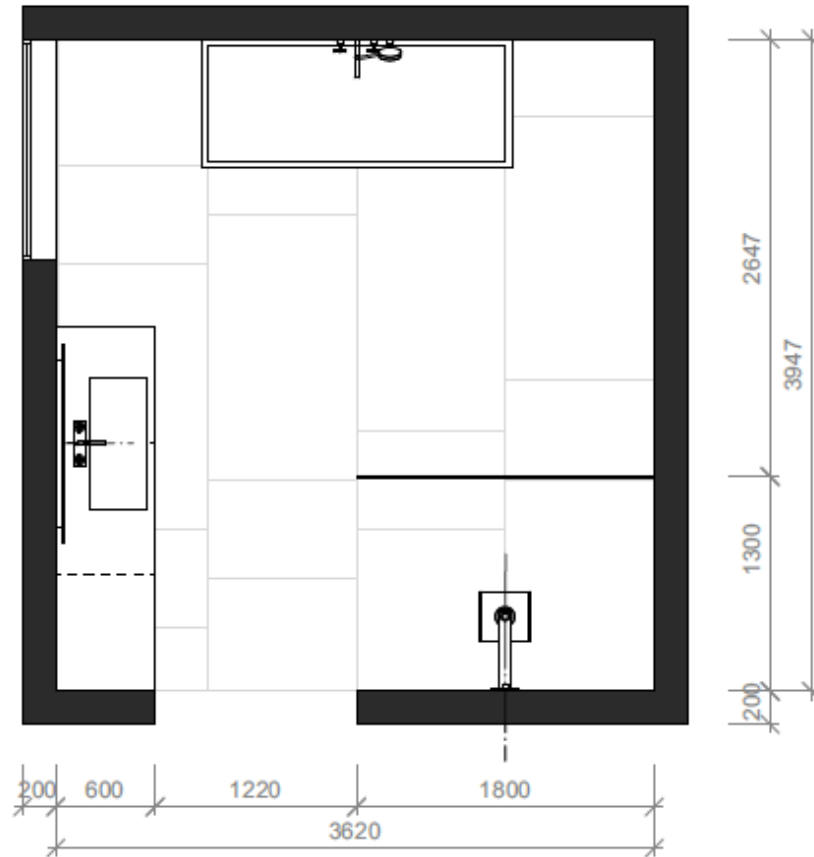

AXOR CITTERIO WASH BASIN



1 x 3-hole basin mixer 170 with spout
140 mm, cross handles, plate and
pop-up waste set
39134, -000

AXOR CITTERIO BATHTUB



1 x 3-hole bath mixer for concealed
installation wall-mounted with cross
handles and plate
39441, -000

1 x Basic set
10303180



2 x Towel hook
42811, -000

AXOR CITTERIO SHOWER



1 x Overhead shower 300/300 2jet
with shower arm
35318, -000

1 x Basic set
35361180



1 x Thermostatic module Select 530/90
for concealed installation for 3 functions
18356, -000

1 x Basic set
18311180



1 x Baton hand shower 2jet
28532, -000



1 x Metal effect shower hose
1.25 m
28282, -000

MANUFACTURER LIST / STYLING / ACCESSORIES



Wash basin:
custom made of natural
stone in the colour „nero
creta"

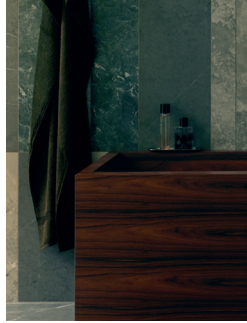

Bathtub:
palisander wooden,
bathtub made by Alegna



Wall material:
Natural stone
Casalgrande Padana
Marmoker (grafite, verde
aver, breccchia carsica)



Floor material:
Natural stone
Casalgrande Padana Marmoker
(grafite)

Carpet:
Naturtex/Barcelona

Towel:
Rhomtuft

Basket:
HK Living



AXOR

AXOR / Hansgrohe SE

Auesstraße 5-9

77761 Schiltach

Germany

info@axor-design.com

axor-design.com