

AXOR



AXOR CITTERIO
PLANNING IDEA – BATHROOM 19M²



S H A N G H A I

THE CITY OF THE FUTURE, IN PROGRESS TODAY

China's most cosmopolitan city, Shanghai is growing at an electrifying pace, not only in size but in prestige and global influence. Indeed, the city is positioned to become a, if not the, leading world metropolis by 2035. In pursuit of this ambition, the local government has created what may be the largest city-wide development plan ever implemented. Although it aims to cap population at current levels and limit overall construction, Shanghai Master Plan 2035 is not about constraining growth so much as creating new possibilities. With a focus on building "a place full of positive energy and vitality," where people can "jog in green spaces close to their homes" and sit on the grass "to watch birds fly by", the plan offers a roadmap to an innovative and sustainable metropolis that prioritizes quality of life. Shanghai has already developed a reputation for attracting the world's leading architects and bringing their most ambitious ideas to fruition. With its new master plan in place, the world's third largest city is destined to become a global epicenter of Compact Luxury.

INTERNATIONAL ELEGANCE:
AN AXOR CITTERIO BATHROOM WITH A
RICH MATERIAL MIX AND A WARM,
WELCOMING AESTHETIC.



With its reduced but luxurious look and feel, the AXOR Citterio Shanghai bathroom design has cosmopolitan appeal. Conceptually, the bathroom is based on Antonio Citterio's philosophy of 'Segmentation, Transparency and Material', all three elements of which contribute to the Compact Luxury experience: First, the space has been carefully planned and segmented. Second, the transparent partitions and open wooden elements provide separation while maximizing the sense of spaciousness. Third, a warm, dark palette of materials gives the bathroom the feeling of a calm retreat.

A DARK, WARM PALETTE OF WOOD
AND NATURAL STONE GIVES THE
BATHROOM THE FEELING OF A CALM
RETREAT FROM HECTIC CITY LIFE.

A floor-to-ceiling, wall-to-wall window amplifies this bathroom's sense of openness. A natural stone monolith, into which two wash basins have been carved, seems to float along the side wall. Mounted at each basin is an AXOR Citterio single-lever faucet featuring the collection's new lever handle. At the freestanding bathtub, crafted from precious palisander, the same handle design tops a floorstanding bath faucet. All three faucets, along with the AXOR products in the shower, are finished in Polished Black Chrome, an exclusive AXOR FinishPlus surface that harmonizes with the bathroom's warm, dark palette.



AXOR CITTERIO BATHROOM 19M²

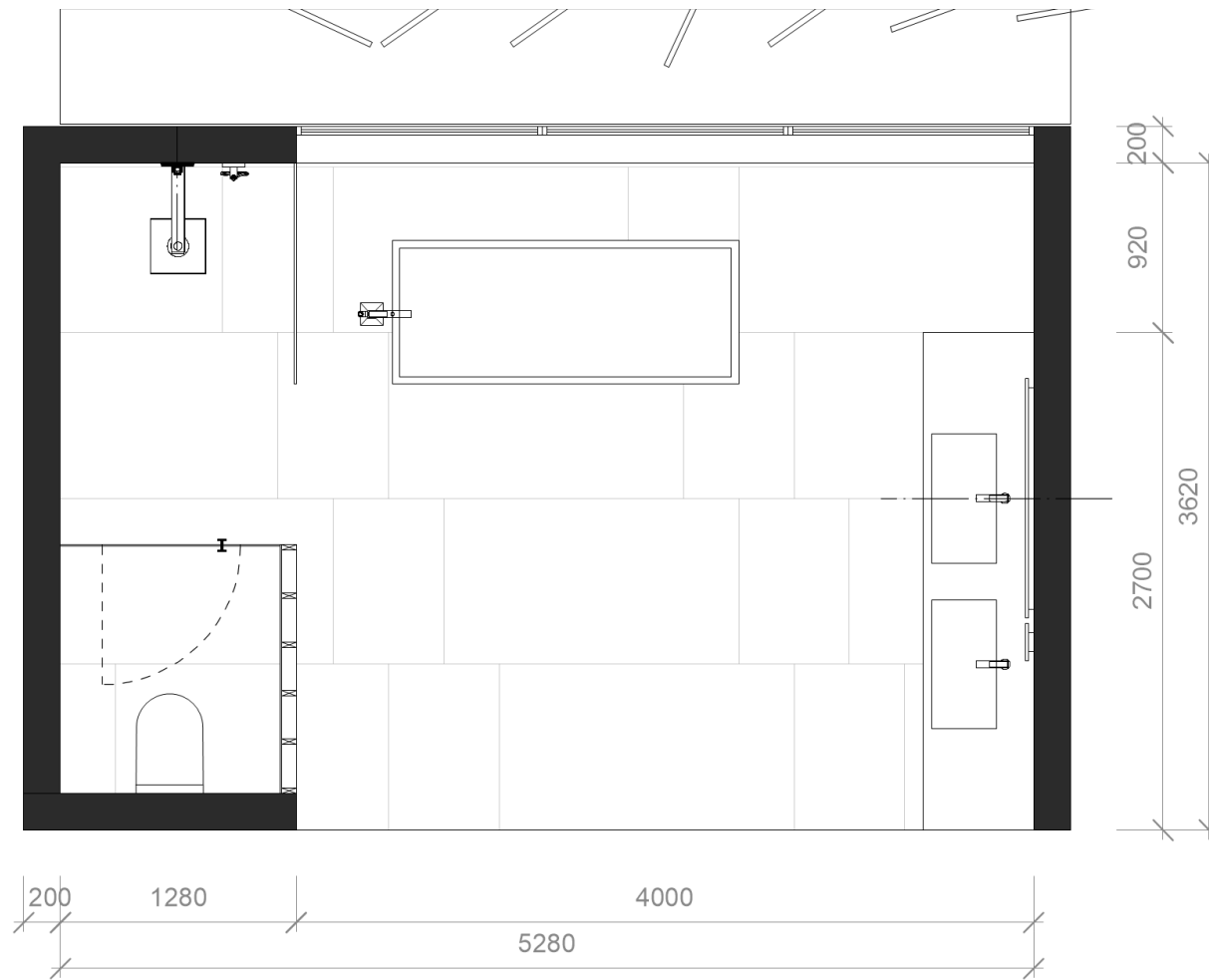

AXOR CITTERIO WASH BASIN



1 x Single lever basin mixer 160
with lever handle and pop-up
waste set
39023, -330



2 x Towel hook
42811, -330

AXOR CITTERIO BATHTUB



1 x Single lever bath mixer floor-standing
with lever handle
39440, -330

Basic set
10452180

AXOR CITTERIO SHOWER



1 x AXOR ShowerSolutions
35314, -330



1 x Porter unit 120/120 with baton hand
shower 2jet and shower hose
12626, -330



1 x Single lever bath mixer for
concealed installation with lever handle
39455, -330

1 x Basic set
01700180



1 x Bath towel holder 800 mm
42880, -330



Wash basin:
Custom made of natural stone
in the colour „nero creta“



Wall material:
Natural stone: Casalgrande
Padana Marmoker (grafite,
verde aver, breccchia carsica)



Floor material:
Natural stone: Casalgrande
Padana Marmoker (grafite)



Bathtub:
Custom made by Alegna,
Material: Palisander

Carpet:
Naturtex/Barcelona

Towels:
Rhomtuft

Stool:
Vintage/Asiatika

Laundry basket:
HK Living

Bench with leather:
B+B italia/Citterio Caratos

Freestanding luminaire:
Venicem/Urban

Table luminaire:
Serax
Ann Demeulemeester
Floor3

Teapot:
Serax

Ceramic stool:
Pols Potten

Metal table:
WalterKnoll/Oki

Wicker chair:
Jeanneret / Detier

Cushion:
Kampe

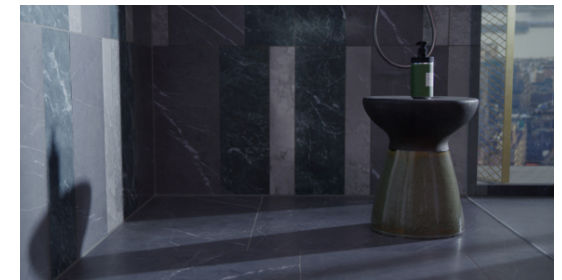

AXOR

AXOR / Hansgrohe SE

Auesstraße 5-9

77761 Schiltach

Germany

info@axor-design.com

axor-design.com